

MC760

COMMERCIAL ROOFING

DETAIL LIST

		<u>Revision</u>	<u>Date</u>
D 00 / 16	COVER SHEET		
D 01 / 16	RIDGE WITH PROFILED APEX	3.0	SEP 2024
D 02 / 16	RIDGE WITH ROUND TOP APEX	3.0	SEP 2024
D 03 / 16	SAWTOOTH RIDGE	3.0	SEP 2024
D 04 / 16	INTERNAL GUTTER	3.0	SEP 2024
D 05 / 16	FLUSH EAVE WITH PAN FIXED GUTTER	3.0	SEP 2024
D 06 / 16	BARGE WITH PROFILED CLADDING	3.0	SEP 2024
D 07 / 16	BARGE OVERHANG	3.0	SEP 2024
D 08 / 16	PARAPET WITH TRANSVERSE APRON	3.0	SEP 2024
D 09 / 16	TRANSVERSE APRON	3.0	SEP 2024
D 10 / 16	PARALLEL APRON	3.0	SEP 2024
D 11 / 16	PARALLEL HIDDEN GUTTER	3.0	SEP 2024
D 12 / 16	PARALLEL HIDDEN GUTTER (2 PART FLASHING)	3.0	SEP 2024
D 13 / 16	ROOF STEP	3.0	SEP 2024
D 14 / 16	TRANSLUCENT SHEETS - LONG SECTION	3.0	SEP 2024
D 15 / 16	TRANSLUCENT SHEETS - CROSS	3.0	SEP 2024
D 16 / 16	3D TRANSLUCENT SHEETS	3.0	SEP 2024

AS PER E2/ASI			
	SITUATION 1	SITUATION 2	SITUATION 3
X	1. LOW, MEDIUM, HIGH WIND ZONES, WHERE ROOF PITCH $\geq 10^\circ$ MIN. 130mm (EXCLUDING ANY SOFT EDGE OR TURN-DOWN TO ROOFING)	1. VERY HIGH WIND ZONE 2. LOW, MEDIUM & HIGH WIND ZONES WHERE ROOF PITCH $\leq 10^\circ$ MIN. 200mm (EXCLUDING ANY SOFT EDGE OR TURN-DOWN TO ROOFING)	1. ALL ROOF PITCHES IN EXTRA HIGH WIND ZONE. MIN. 200mm (EXCLUDING ANY SOFT EDGE OR TURN-DOWN TO ROOFING)

PRE-FINISHED RIDGE CAP FLASHING

STOPENDS TO ROOF CLADDING

METALCRAFT MC760 ROOFING

SOFT EDGE OR NOTCHED DRESSED OVER MC760 RIBS

PERMEABLE UNDERLAY & NETTING SHOWN DASHED

SAFETY MESH TO WORKSAFE NZ REQUIREMENTS

PRE-FINISHED SELF DRILLING/TAPPING SCREW WITH NEOPRENE WASHER

METALCRAFT MSS PURLIN BY ENGINEER

STRUCTURAL STEEL FRAMING BY ENGINEER

* MC760 MIN. ROOF PITCH = 3°

AS PER MRM CODE OF PRACTICE				
	CATEGORY A	CATEGORY B	CATEGORY C	CATEGORY D
X	LOW, MEDIUM OR HIGH WIND ZONES - ALL ROOF PITCHES VERY HIGH AND EXTRA HIGH WIND ZONES WHERE THE PITCH IS EQUAL TO OR GREATER THAN 10° MIN. 130mm	VERY HIGH WIND ZONES ROOF PITCH $< 8^\circ$ EXTRA HIGH WIND ZONES - ALL ROOF PITCHES MIN. 200mm	SED WIND ZONES UP TO 60 m/s ALL ROOF PITCH MIN. 200mm	SED WIND ZONES UP TO 68 m/s ALL ROOF PITCH MIN. 200mm + BAFFLE (REFER NZ MRM COP)



DISCLAIMER:
All details are to be used for indicative purposes only and the designer should consult both the MRM code of practice and E2 and all other relevant building codes
Details of the supporting mechanisms are indicative only. Compliance of the supporting mechanisms is the responsibility of the designer. Construction detail can vary for wall cladding. The underlay is detailed as a single line for simplicity and is indicative only. Building paper type and method of installation should comply with underlay manufacturers recommendations and NZBC regulations.

AS PER E2/ASI			
	SITUATION 1 1. LOW, MEDIUM, HIGH WIND ZONES, WHERE ROOF PITCH $\geq 10^\circ$ X MIN. 130mm (EXCLUDING ANY SOFT EDGE OR TURN-DOWN TO ROOFING)	SITUATION 2 1. VERY HIGH WIND ZONE 2. LOW, MEDIUM & HIGH WIND ZONES WHERE ROOF PITCH $\leq 10^\circ$ X MIN. 200mm (EXCLUDING ANY SOFT EDGE OR TURN-DOWN TO ROOFING)	SITUATION 3 1. ALL ROOF PITCHES IN EXTRA HIGH WIND ZONE. X MIN. 200mm (EXCLUDING ANY SOFT EDGE OR TURN-DOWN TO ROOFING)

PRE-FINISHED RIDGE ROUND CAP FLASHING

STOPENDS TO ROOF CLADDING

METALCRAFT MC760 ROOFING

SOFT EDGE OR NOTCHED DRESSED OVER MC760 RIBS

PRE-FINISHED SELF DRILLING/TAPPING SCREW WITH NEOPRENE WASHER

METALCRAFT MSS PURLIN BY ENGINEER

STRUCTURAL STEEL FRAMING BY ENGINEER

PERMEABLE UNDERLAY & NETTING SHOWN DASHED

SAFETY MESH TO WORKSAFE NZ REQUIREMENTS

* MC760 MIN. ROOF PITCH = 3°

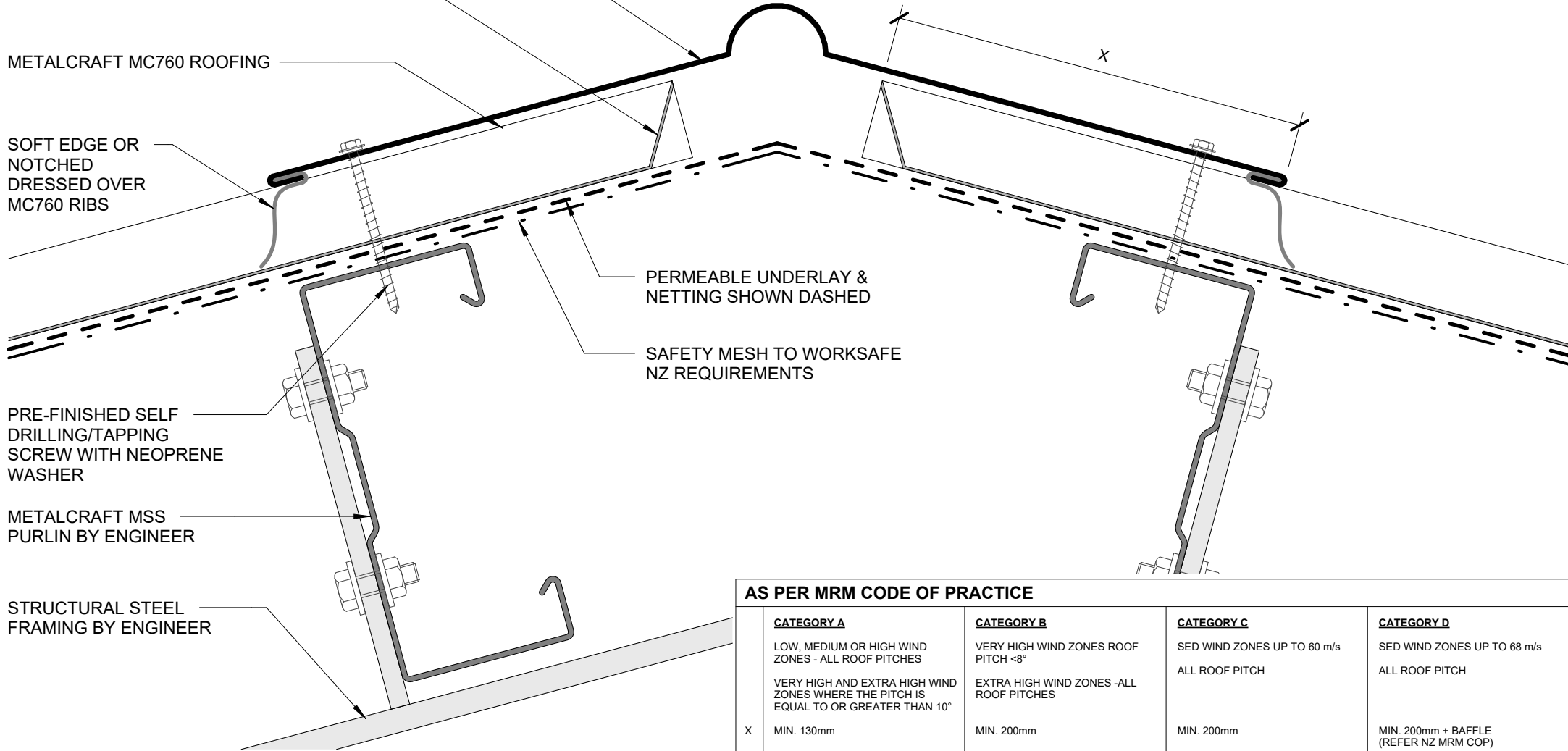

AS PER MRM CODE OF PRACTICE			
CATEGORY A LOW, MEDIUM OR HIGH WIND ZONES - ALL ROOF PITCHES VERY HIGH AND EXTRA HIGH WIND ZONES WHERE THE PITCH IS EQUAL TO OR GREATER THAN 10° X MIN. 130mm	CATEGORY B VERY HIGH WIND ZONES ROOF PITCH $< 8^\circ$ EXTRA HIGH WIND ZONES - ALL ROOF PITCHES MIN. 200mm	CATEGORY C SED WIND ZONES UP TO 60 m/s ALL ROOF PITCH MIN. 200mm	CATEGORY D SED WIND ZONES UP TO 68 m/s ALL ROOF PITCH MIN. 200mm + BAFFLE (REFER NZ MRM COP)

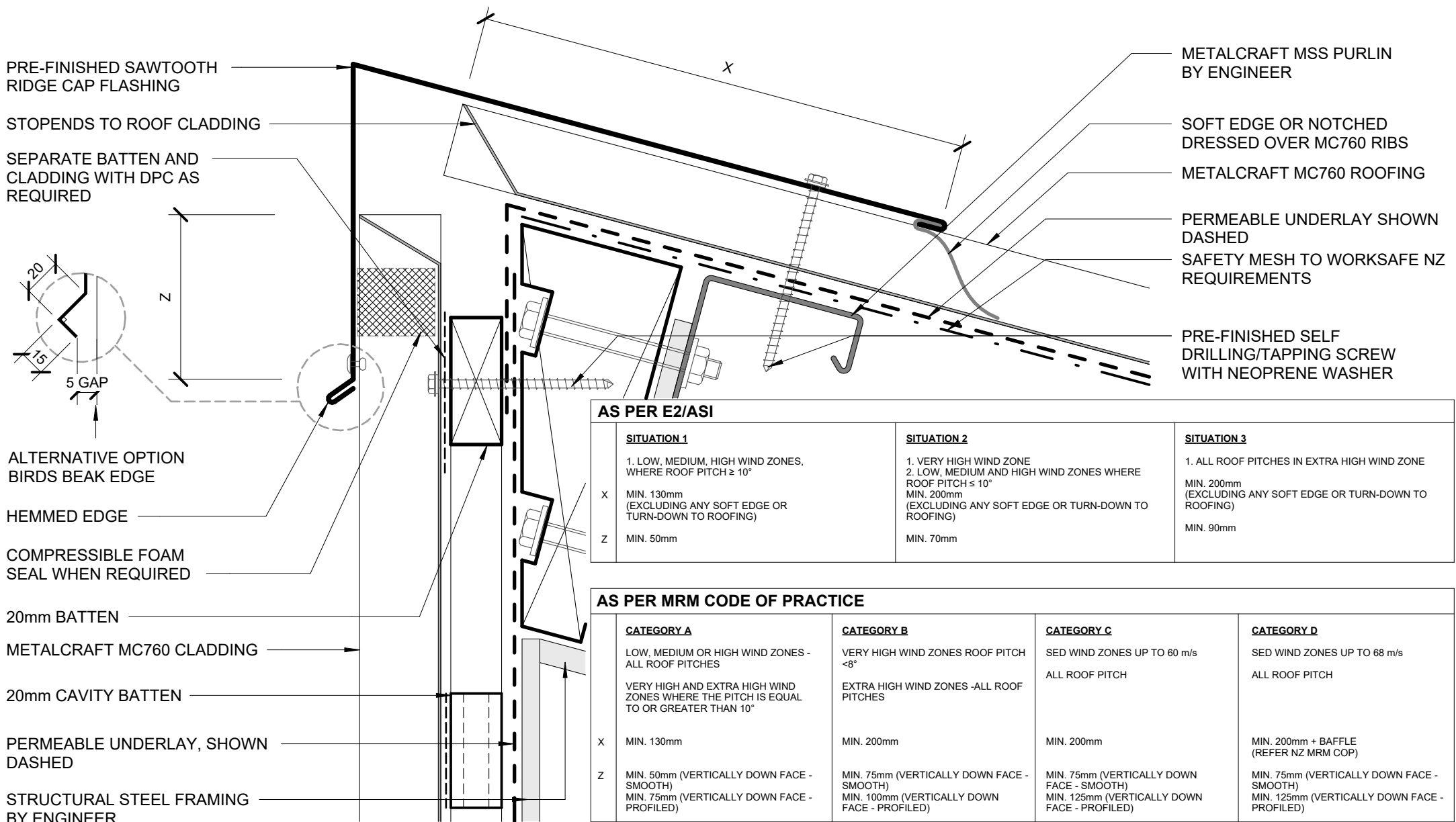

AS PER E2/ASI

	<u>SITUATION 1</u>	<u>SITUATION 2</u>	<u>SITUATION 3</u>
	1. LOW, MEDIUM, HIGH WIND ZONES, WHERE ROOF PITCH ≥ 10°	1. VERY HIGH WIND ZONE 2. LOW, MEDIUM AND HIGH WIND ZONES WHERE ROOF PITCH ≤ 10°	1. ALL ROOF PITCHES IN EXTRA HIGH WIND ZONE
X	MIN. 130mm (EXCLUDING ANY SOFT EDGE OR TURN-DOWN TO ROOFING)	MIN. 200mm (EXCLUDING ANY SOFT EDGE OR TURN-DOWN TO ROOFING)	MIN. 200mm (EXCLUDING ANY SOFT EDGE OR TURN-DOWN TO ROOFING)
Z	MIN. 50mm	MIN. 70mm	MIN. 90mm

AS PER MRM CODE OF PRACTICE

	<u>CATEGORY A</u>	<u>CATEGORY B</u>	<u>CATEGORY C</u>	<u>CATEGORY D</u>
	LOW, MEDIUM OR HIGH WIND ZONES - ALL ROOF PITCHES VERY HIGH AND EXTRA HIGH WIND ZONES WHERE THE PITCH IS EQUAL TO OR GREATER THAN 10°	VERY HIGH WIND ZONES ROOF PITCH <8° EXTRA HIGH WIND ZONES - ALL ROOF PITCHES	SED WIND ZONES UP TO 60 m/s ALL ROOF PITCH	SED WIND ZONES UP TO 68 m/s ALL ROOF PITCH
X	MIN. 130mm	MIN. 200mm	MIN. 200mm	MIN. 200mm + BAFFLE (REFER NZ MRM COP)
Z	MIN. 50mm (VERTICALLY DOWN FACE - SMOOTH) MIN. 75mm (VERTICALLY DOWN FACE - PROFILED)	MIN. 75mm (VERTICALLY DOWN FACE - SMOOTH) MIN. 100mm (VERTICALLY DOWN FACE - PROFILED)	MIN. 75mm (VERTICALLY DOWN FACE - SMOOTH) MIN. 125mm (VERTICALLY DOWN FACE - PROFILED)	MIN. 75mm (VERTICALLY DOWN FACE - SMOOTH) MIN. 125mm (VERTICALLY DOWN FACE - PROFILED)

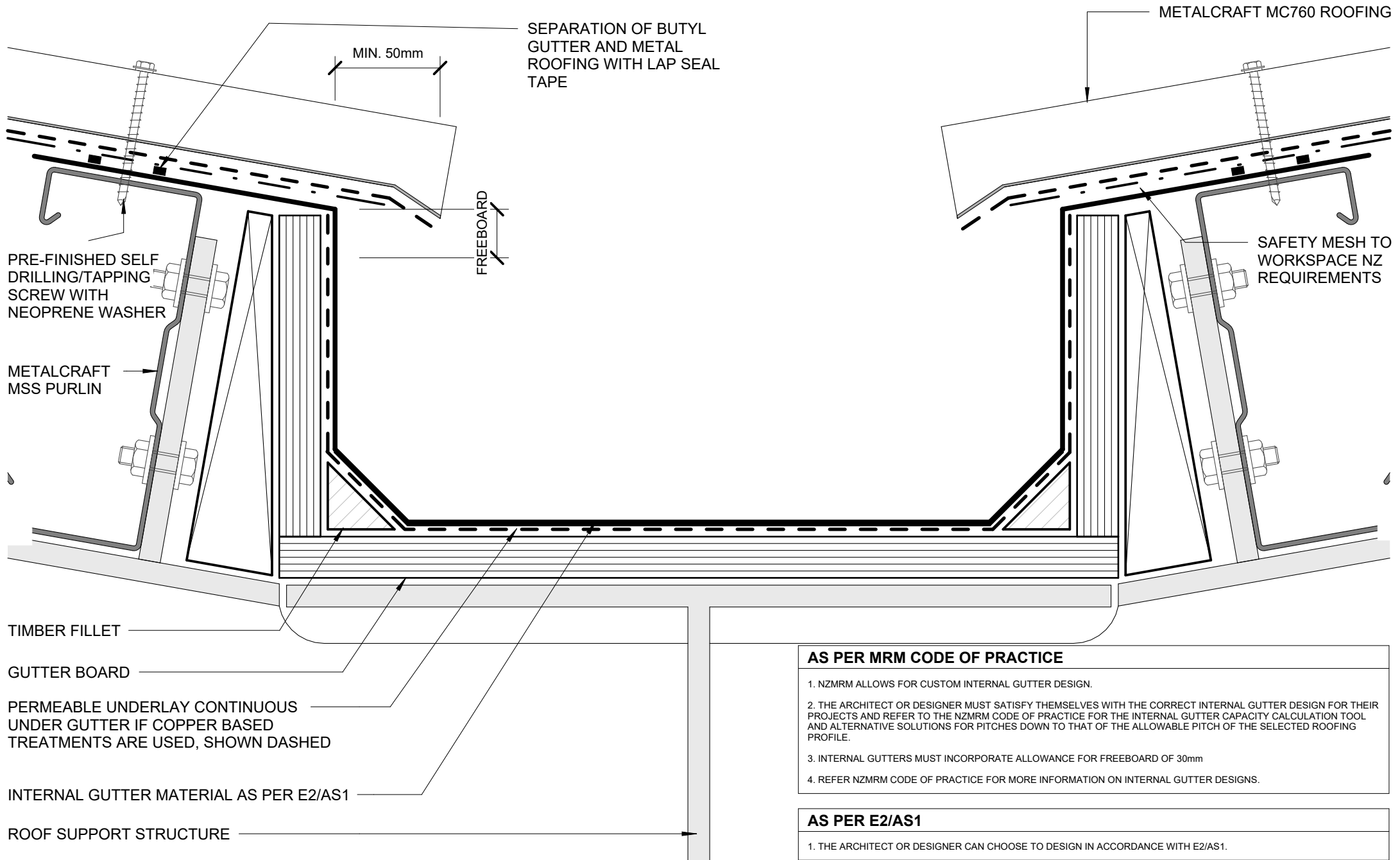

AS PER MRM CODE OF PRACTICE

1. NZMRM ALLOWS FOR CUSTOM INTERNAL GUTTER DESIGN.
2. THE ARCHITECT OR DESIGNER MUST SATISFY THEMSELVES WITH THE CORRECT INTERNAL GUTTER DESIGN FOR THEIR PROJECTS AND REFER TO THE NZMRM CODE OF PRACTICE FOR THE INTERNAL GUTTER CAPACITY CALCULATION TOOL AND ALTERNATIVE SOLUTIONS FOR PITCHES DOWN TO THAT OF THE ALLOWABLE PITCH OF THE SELECTED ROOFING PROFILE.
3. INTERNAL GUTTERS MUST INCORPORATE ALLOWANCE FOR FREEBOARD OF 30mm
4. REFER NZMRM CODE OF PRACTICE FOR MORE INFORMATION ON INTERNAL GUTTER DESIGNS.

AS PER E2/AS1

1. THE ARCHITECT OR DESIGNER CAN CHOOSE TO DESIGN IN ACCORDANCE WITH E2/AS1.

EAVE FLASHING REQUIRED WHEN ALL OF THE FOLLOWING CONDITIONS ARE MET:
 ROOF PITCH $\leq 10^\circ$
 SOFFIT WIDTH $\leq 100\text{mm}$
 WIND ZONES = VERY HIGH OR EXTRA HIGH

OTHER SITUATION - ENGINEER SPECIFIC DESIGN
 MRM RECOMMENDS TO USE IN AREAS EXPOSED TO CONTAMINATORS SUCH AS SEA SALT OR INDUSTRIAL POLLUTANTS

UNDERLAY TERMINATES AT TOP OF GUTTER EAVES FLASHING AND WHEN NO GUTTER EAVES IS REQUIRED UNDERLAY MUST NOT OVERHANG THE GUTTER BY MORE THAN 20mm

METALCRAFT MC760 ROOFING

PERMEABLE UNDERLAY & NETTING SHOWN DASHED

METALCRAFT BOX GUTTER 125 WITH EXTERNAL BRACKET

PRE-FINISHED EAVE FLASHING CUT BACK AROUND INTERNAL GUTTER BRACKETS IF REQUIRED

PRE-FINISHED SELF DRILLING/TAPPING SCREW WITH NEOPRENE WASHER

SEPARATE BATTEN AND CLADDING WITH DPC AS REQUIRED

DPC SEPERATION AS REQUIRED

METALCRAFT MC760 CLADDING ON CAVITY

COMPRESSIBLE FOAM SEAL WHEN REQUIRED

METALCRAFT MSS PURLIN BY ENGINEER

$<10^\circ$ OR UN-BAFFLED BY SPOUTING = 70mm
 $10-35^\circ$ = 50mm
 $>35^\circ$ = 40mm

DIMENSION TO SUIT
 SUGGEST MIN. 125mm

* MC700
 MIN. ROOF PITCH = 3°
 15°
 0°

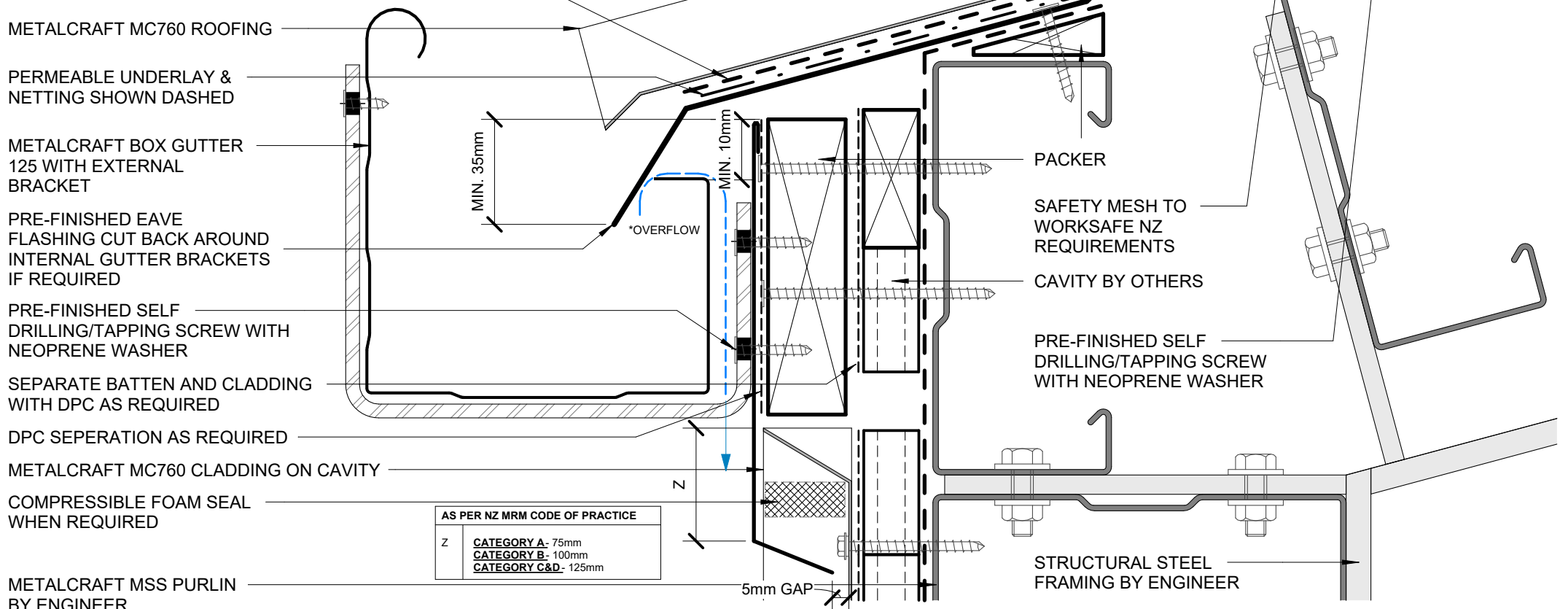

AS PER NZ MRM CODE OF PRACTICE	
Z	CATEGORY A - 75mm
	CATEGORY B - 100mm
	CATEGORY C&D - 125mm

FLASHING SHOULD NOT EXCEED 300mm.
A TURNED UP PAN EDGE TO FULL CREST HEIGHT (RIB) CONSTITUTES A CREST.

UNDERSOAKER
FLASHING REQUIRED
FOR NZ MRM COP
CATEGORY D ONLY

PRE-FINISHED
SEALED POP RIVET
OR PRE-FINISHED 8g
WAFER-TEK SCREW

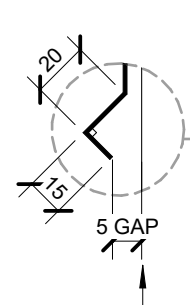

ALTERNATIVE OPTION
BIRDS BEAK EDGE

COMPRESSIBLE FOAM
SEAL WHEN REQUIRED

20mm CAVITY

METALCRAFT MSS PURLIN
BY ENGINEER

20mm CAVITY BATTEN

METALCRAFT MC760
CLADDING

PERMEABLE UNDERLAY
SHOWN DASHED

SAFETY MESH TO WORKSAFE
NZ REQUIREMENTS

PRE-FINISHED BARGE FLASHING

METALCRAFT MC760 ROOFING

PERMEABLE UNDERLAY &
NETTING SHOWN DASHED

X

5-10mm

±5mm GAP

PRE-FINISHED SELF DRILLING/TAPPING
SCREW WITH NEOPRENE WASHER

AS PER E2/ASI			
	SITUATION 1	SITUATION 2	SITUATION 3
	1. LOW, MEDIUM, HIGH WIND ZONES WHERE ROOF PITCH $\geq 10^\circ$	1. ALL ROOF PITCHES IN VERY HIGH WIND ZONE 2. LOW, MEDIUM AND HIGH WIND ZONES WHERE ROOF PITCH $\leq 10^\circ$	1. ALL ROOF PITCHES IN EXTRA HIGH WIND ZONE.
X	AT LEAST TWO CRESTS	AT LEAST TWO CRESTS	AT LEAST TWO CRESTS
Z	MIN. 50mm	MIN. 70mm	MIN. 90mm

AS PER MRM CODE OF PRACTICE				
	CATEGORY A	CATEGORY B	CATEGORY C	CATEGORY D
	LOW, MEDIUM OR HIGH WIND ZONES - ALL ROOF PITCHES VERY HIGH AND EXTRA HIGH WIND ZONES WHERE THE PITCH IS EQUAL TO OR GREATER THAN 10°	VERY HIGH WIND ZONES ROOF PITCH $< 8^\circ$ EXTRA HIGH WIND ZONES - ALL ROOF PITCHES	SED WIND ZONES UP TO 60 m/s ALL ROOF PITCH	SED WIND ZONES UP TO 68 m/s ALL ROOF PITCH
X	TRAPEZOIDAL & TRAY: ONE RIB CORRUGATE: 2 CORRUGATIONS	TRAPEZOIDAL & TRAY: TWO RIBS (20mm - 34mm)* ONE RIB (>34mm)* CORRUGATE: 2 CORRUGATIONS	TRAPEZOIDAL & TRAY: TWO RIBS (20mm - 34mm)* ONE RIB (>34mm)* CORRUGATE: 3 CORRUGATIONS	TRAPEZOIDAL & TRAY: TWO RIBS (20mm - 34mm)* + UNDERSOAKER ONE RIB (>34mm)* + UNDERSOAKER CORRUGATE: 2 CORRUGATIONS + UNDERSOAKER
Z	MIN. 50mm (VERTICALLY DOWN FACE - SMOOTH) MIN. 75mm (VERTICALLY DOWN FACE - PROFILED)	MIN. 75mm (VERTICALLY DOWN FACE - SMOOTH) MIN. 100mm (VERTICALLY DOWN FACE - PROFILED)	MIN. 75mm (VERTICALLY DOWN FACE - SMOOTH) MIN. 125mm (VERTICALLY DOWN FACE - PROFILED)	MIN. 75mm (VERTICALLY DOWN FACE - SMOOTH) MIN. 125mm (VERTICALLY DOWN FACE - PROFILED)

* RIB HEIGHT OF PROFILE OR TURNUP

FLASHING SHOULD NOT EXCEED 300mm.
A TURNED UP PAN EDGE TO FULL CREST
HEIGHT (RIB) CONSTITUTES A CREST.

UNDERSOAKER
FLASHING REQUIRED
FOR NZ MRM COP
CATEGORY D ONLY

PRE-FINISHED
BARGE FLASHING

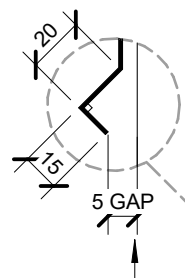

ALTERNATIVE
OPTION
BIRDS BEAK EDGE

HEMMED EDGE

PRE-FINISHED SELF
DRILLING/TAPPING SCREW
WITH NEOPRENE WASHER

PERMEABLE UNDERLAY &
NETTING SHOWN DASHED

BARGE BOARD PRE
PRIMED

SOFFIT LINING

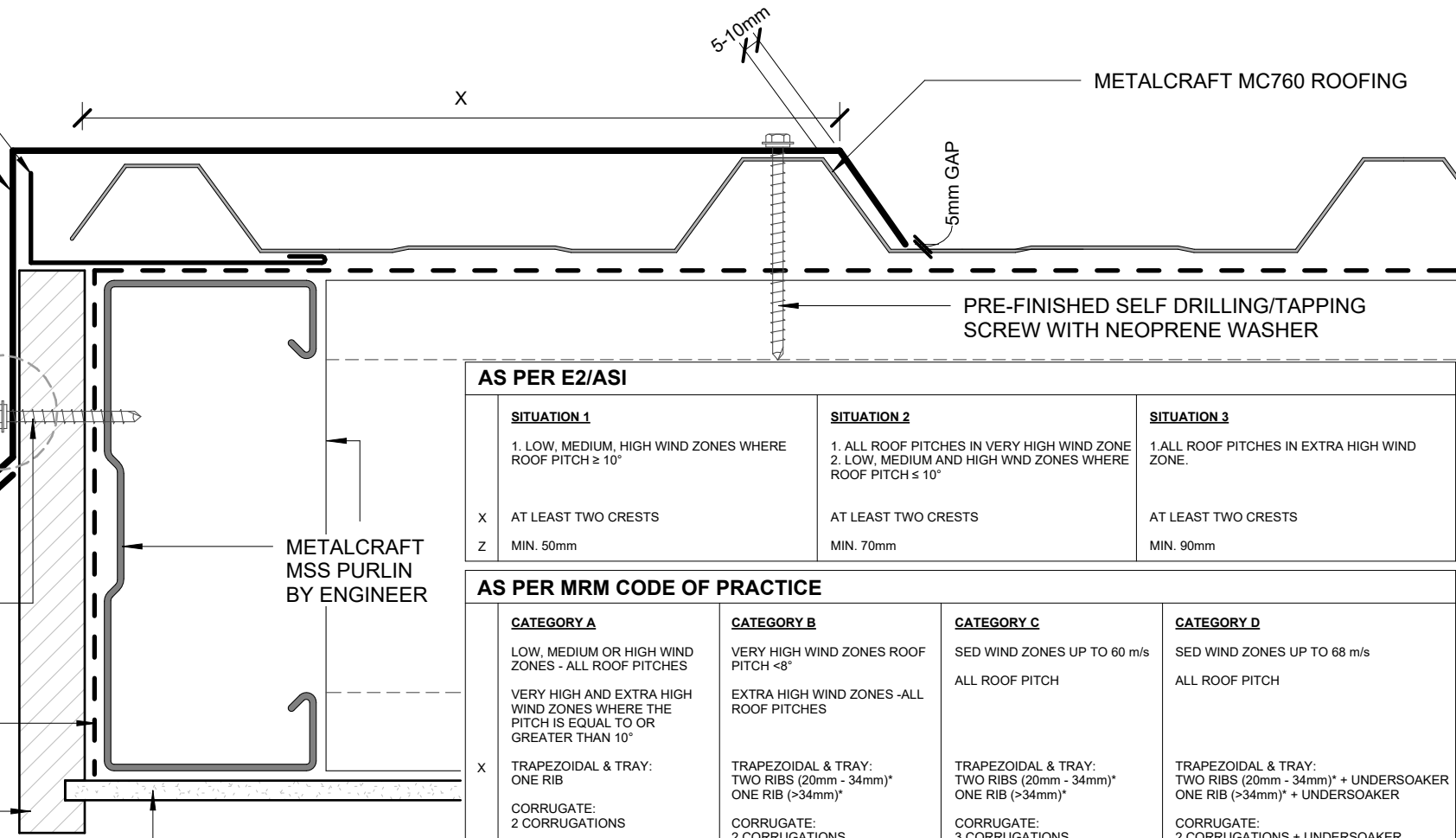

AS PER E2/ASI			
	SITUATION 1	SITUATION 2	SITUATION 3
	1. LOW, MEDIUM, HIGH WIND ZONES WHERE ROOF PITCH $\geq 10^\circ$	1. ALL ROOF PITCHES IN VERY HIGH WIND ZONE 2. LOW, MEDIUM AND HIGH WIND ZONES WHERE ROOF PITCH $\leq 10^\circ$	1. ALL ROOF PITCHES IN EXTRA HIGH WIND ZONE.
X	AT LEAST TWO CRESTS	AT LEAST TWO CRESTS	AT LEAST TWO CRESTS
Z	MIN. 50mm	MIN. 70mm	MIN. 90mm

AS PER MRM CODE OF PRACTICE				
	CATEGORY A	CATEGORY B	CATEGORY C	CATEGORY D
	LOW, MEDIUM OR HIGH WIND ZONES - ALL ROOF PITCHES VERY HIGH AND EXTRA HIGH WIND ZONES WHERE THE PITCH IS EQUAL TO OR GREATER THAN 10°	VERY HIGH WIND ZONES ROOF PITCH $< 8^\circ$ EXTRA HIGH WIND ZONES -ALL ROOF PITCHES	SED WIND ZONES UP TO 60 m/s ALL ROOF PITCH	SED WIND ZONES UP TO 68 m/s ALL ROOF PITCH
X	TRAPEZOIDAL & TRAY: ONE RIB CORRUGATE: 2 CORRUGATIONS	TRAPEZOIDAL & TRAY: TWO RIBS (20mm - 34mm)* ONE RIB ($>34mm$)*	TRAPEZOIDAL & TRAY: TWO RIBS (20mm - 34mm)* ONE RIB ($>34mm$)*	TRAPEZOIDAL & TRAY: TWO RIBS (20mm - 34mm)* + UNDERSOAKER ONE RIB ($>34mm$)* + UNDERSOAKER
Z	MIN. 50mm (VERTICALLY DOWN FACE - SMOOTH) MIN. 75mm (VERTICALLY DOWN FACE - PROFILED)	MIN. 75mm (VERTICALLY DOWN FACE - SMOOTH) MIN. 100mm (VERTICALLY DOWN FACE - PROFILED)	MIN. 75mm (VERTICALLY DOWN FACE - SMOOTH) MIN. 125mm (VERTICALLY DOWN FACE - PROFILED)	MIN. 75mm (VERTICALLY DOWN FACE - SMOOTH) MIN. 125mm (VERTICALLY DOWN FACE - PROFILED)

* RIB HEIGHT OF PROFILE OR TURNUP

COMPRESSIBLE FOAM SEAL WHEN REQUIRED

CONTINUOUS
TIMBER PACKING

PRE-FINISHED
PARAPET CAP
FLASHING

Z

SEPARATE BATTEN
AND CLADDING WITH
DPC AS REQUIRED

PRE-FINISHED FLAT
HEAD EXPANDING
MASONRY ANCHOR
SCREW WITH
NEOPRENE WASHER
FOR FLASHING

PVC CAVITY CLOSER

METALCRAFT MC760
CLADDING ON CAVITY

PERMEABLE
UNDERLAY &
NETTING SHOWN
DASHED

STOPENDS ROOF
CLADDING

METALCRAFT MSS
PURLIN BY ENGINEER

CONCRETE WALL
BY ENGINEER

MIN. 5.00°

AS PER E2/ASI

	SITUATION 1	SITUATION 2	SITUATION 3
	1. LOW, MEDIUM, HIGH WIND ZONES, WHERE ROOF PITCH $\geq 10^\circ$	1. VERY HIGH WIND ZONE 2. LOW, MEDIUM AND HIGH WIND ZONES WHERE ROOF PITCHES $\leq 10^\circ$	1. ALL ROOF PITCHES IN EXTRA HIGH WIND ZONE
G	MIN. 35mm	MIN. 35mm	MIN. 35mm
N	MIN. 75mm	MIN. 75mm	MIN. 75mm
L	MIN. 130mm (EXCLUDING ANY SOFT EDGE OR TURN-DOWN TO ROOFING)	MIN. 200mm (EXCLUDING ANY SOFT EDGE OR TURN-DOWN TO ROOFING)	MIN. 200mm (EXCLUDING ANY SOFT EDGE OR TURN-DOWN TO ROOFING)
Z	MIN. 50mm	MIN. 70mm	MIN. 90mm

AS PER MRM CODE OF PRACTICE

	CATEGORY A	CATEGORY B	CATEGORY C	CATEGORY D
	LOW, MEDIUM OR HIGH WIND ZONES - ALL ROOF PITCHES	VERY HIGH WIND ZONES ROOF PITCH $< 8^\circ$	SED WIND ZONES UP TO 60 m/s	SED WIND ZONES UP TO 68 m/s
	VERY HIGH AND EXTRA HIGH WIND ZONES WHERE THE PITCH IS EQUAL TO OR GREATER THAN 10°	EXTRA HIGH WIND ZONES - ALL ROOF PITCHES	ALL ROOF PITCH	ALL ROOF PITCH
G	25mm	25mm	25mm	25mm
N	MIN. 50mm + HEM QR 75mm (VERTICALLY UP FACE - SMOOTH) MIN. 75mm + HEM QR 100mm (VERTICALLY UP FACE - PROFILED)	MIN. 75mm + HEM QR 100mm (VERTICALLY UP FACE - SMOOTH) MIN. 100mm + HEM QR 125mm (VERTICALLY UP FACE - PROFILED)	MIN. 100mm + HEM QR 125mm (VERTICALLY UP FACE - SMOOTH) MIN. 125mm + HEM (VERTICALLY UP FACE - PROFILED)	MIN. 100mm + HEM QR 125mm (VERTICALLY UP FACE - SMOOTH) MIN. 125mm + HEM (VERTICALLY UP FACE - PROFILED)
L	MIN. 130mm	MIN. 200mm	MIN. 200mm + BAFFLE (REFER NZ MRM COP)	MIN. 200mm + BAFFLE (REFER NZ MRM COP)
Z	MIN. 50mm (VERTICALLY DOWN FACE - SMOOTH) MIN. 75mm (VERTICALLY DOWN FACE - PROFILED)	MIN. 75mm (VERTICALLY DOWN FACE - SMOOTH) MIN. 100mm (VERTICALLY DOWN FACE - PROFILED)	MIN. 100mm (VERTICALLY DOWN FACE - SMOOTH) MIN. 125mm (VERTICALLY DOWN FACE - PROFILED)	MIN. 100mm (VERTICALLY DOWN FACE - SMOOTH) MIN. 125mm (VERTICALLY DOWN FACE - PROFILED)

* MC760
MIN. ROOF PITCH = 3°

15.00°

PRE-FINISHED APRON FLASHING

PRE-FINISHED SELF
DRILLING/TAPPING SCREW WITH
NEOPRENE WASHER

METALCRAFT MC760 ROOFING

SOFT EDGE OR NOTCHED DRESSED
OVER MC760 RIBS

SAFETY MESH TO WORKSAFE NZ
REQUIREMENTS

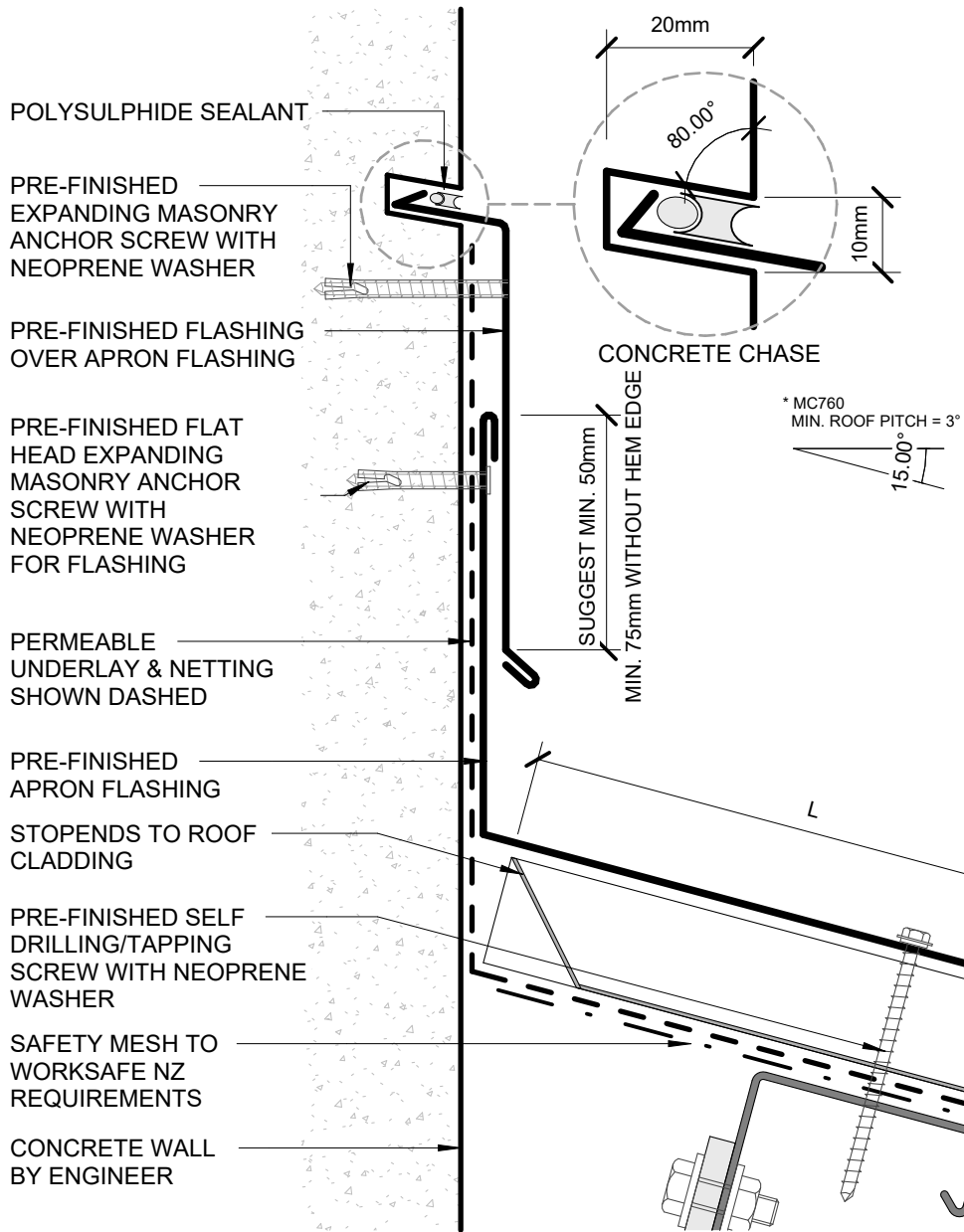

AS PER E2/ASI

	SITUATION 1	SITUATION 2	SITUATION 3
L	1. LOW, MEDIUM, HIGH WIND ZONES, WHERE ROOF PITCH $\geq 10^\circ$ MIN. 130mm (EXCLUDING ANY SOFT EDGE OR TURN-DOWN TO ROOFING)	1. VERY HIGH WIND ZONE 2. LOW, MEDIUM, AND HIGH WIND ZONES WHERE ROOF PITCH $\leq 10^\circ$ MIN. 200mm (EXCLUDING ANY SOFT EDGE OR TURN-DOWN TO ROOFING)	1. ALL ROOF PITCHES EXTRA HIGH WIND ZONE MIN. 200mm (EXCLUDING ANY SOFT EDGE OR TURN-DOWN TO ROOFING)

AS PER MRM CODE OF PRACTICE

	CATEGORY A	CATEGORY B	CATEGORY C	CATEGORY D
L	LOW, MEDIUM OR HIGH WIND ZONES - ALL ROOF PITCHES VERY HIGH AND EXTRA HIGH WIND ZONES WHERE THE PITCH IS EQUAL TO OR GREATER THAN 10° MIN. 130mm	VERY HIGH WIND ZONES ROOF PITCH $< 8^\circ$ EXTRA HIGH WIND ZONES - ALL ROOF PITCHES MIN. 200mm	SED WIND ZONES UP TO 60 m/s ALL ROOF PITCH MIN. 200mm + BAFFLE (REFER NZ MRM COP)	SED WIND ZONES UP TO 68 m/s ALL ROOF PITCH MIN. 200mm + BAFFLE (REFER NZ MRM COP)

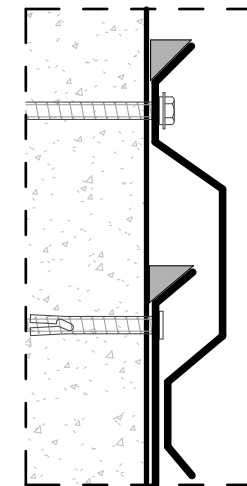

FACE FIXED ALTERNATIVE

- SOFT EDGE OR NOTCHED DRESSED OVER MC760 RIBS
- METALCRAFT MC760 ROOFING
- METALCRAFT MSS PURLIN BY ENGINEER

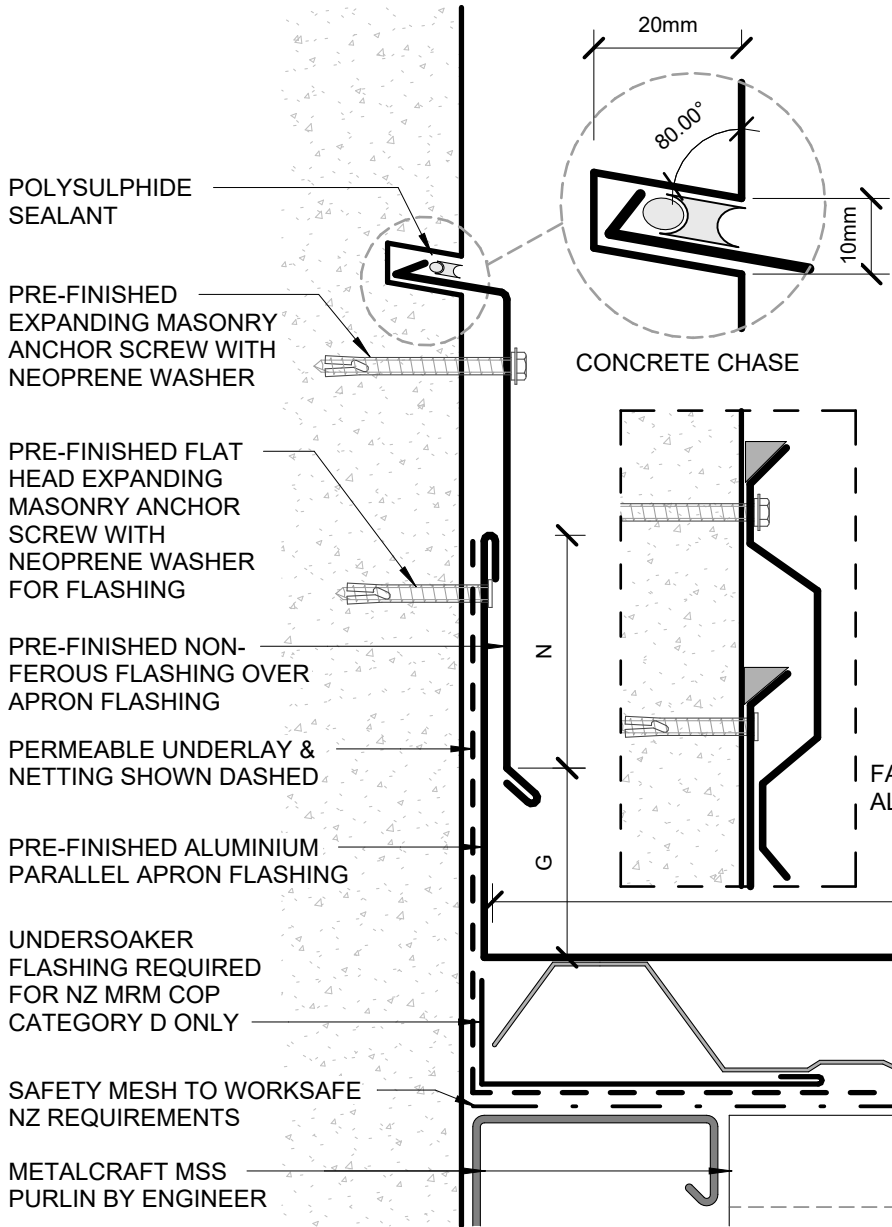

AS PER E2/ASI			
	SITUATION 1	SITUATION 2	SITUATION 3
	1. LOW, MEDIUM, HIGH WIND ZONES, WHERE ROOF PITCH $\geq 10^\circ$	1. ALL ROOF PITCHES IN VERY HIGH WIND ZONE 2. LOW, MEDIUM, AND HIGH WIND ZONES WHERE ROOF PITCH $\leq 10^\circ$	1. ALL ROOF PITCHES IN EXTRA HIGH WIND ZONE
G	MIN. 35mm	MIN. 35mm	MIN. 35mm
N	MIN. 75mm	MIN. 75mm	MIN. 75mm
M	AT LEAST TWO CRESTS	AT LEAST TWO CRESTS	AT LEAST TWO CRESTS

AS PER MRM CODE OF PRACTICE				
	CATEGORY A	CATEGORY B	CATEGORY C	CATEGORY D
	LOW, MEDIUM OR HIGH WIND ZONES - ALL ROOF PITCHES VERY HIGH AND EXTRA HIGH WIND ZONES WHERE THE PITCH IS EQUAL TO OR GREATER THAN 10°	VERY HIGH WIND ZONES ROOF PITCH $< 8^\circ$ EXTRA HIGH WIND ZONES - ALL ROOF PITCHES	SED WIND ZONES UP TO 60 m/s ALL ROOF PITCH	SED WIND ZONES UP TO 68 m/s ALL ROOF PITCH
G	25mm	25mm	25mm	25mm
N	MIN. 50mm + HEM OR 75mm (VERTICALLY UP FACE - SMOOTH) MIN. 75mm + HEM OR 100mm (VERTICALLY UP FACE - PROFILED)	MIN. 75mm + HEM OR 100mm (VERTICALLY UP FACE - SMOOTH) MIN. 100mm + HEM OR 125mm (VERTICALLY UP FACE - PROFILED)	MIN. 100mm + HEM OR 125mm (VERTICALLY UP FACE - SMOOTH) MIN. 125mm + HEM (VERTICALLY UP FACE - PROFILED)	MIN. 100mm + HEM OR 125mm (VERTICALLY UP FACE - SMOOTH) MIN. 125mm + HEM (VERTICALLY UP FACE - PROFILED)
M	TRAPEZOIDAL & TRAY: ONE RIB CORRUGATE: 2 CORRUGATIONS	TRAPEZOIDAL & TRAY: TWO RIBS (20mm - 34mm)* ONE RIB ($> 34mm$)* CORRUGATE: 2 CORRUGATIONS	TRAPEZOIDAL & TRAY: TWO RIBS (20mm - 34mm)* ONE RIB ($> 34mm$)* CORRUGATE: 3 CORRUGATIONS	TRAPEZOIDAL & TRAY: TWO RIBS (20mm - 34mm)* + UNDERSOAKER ONE RIB ($> 34mm$)* + UNDERSOAKER CORRUGATE: 2 CORRUGATIONS + UNDERSOAKER
* RIB HEIGHT OF PROFILE OR TURNUP				

FLASHING SHOULD NOT EXCEED 300mm. A TURNED UP PAN EDGE TO FULL CREST HEIGHT (RIB) CONSTITUTES A CREST.

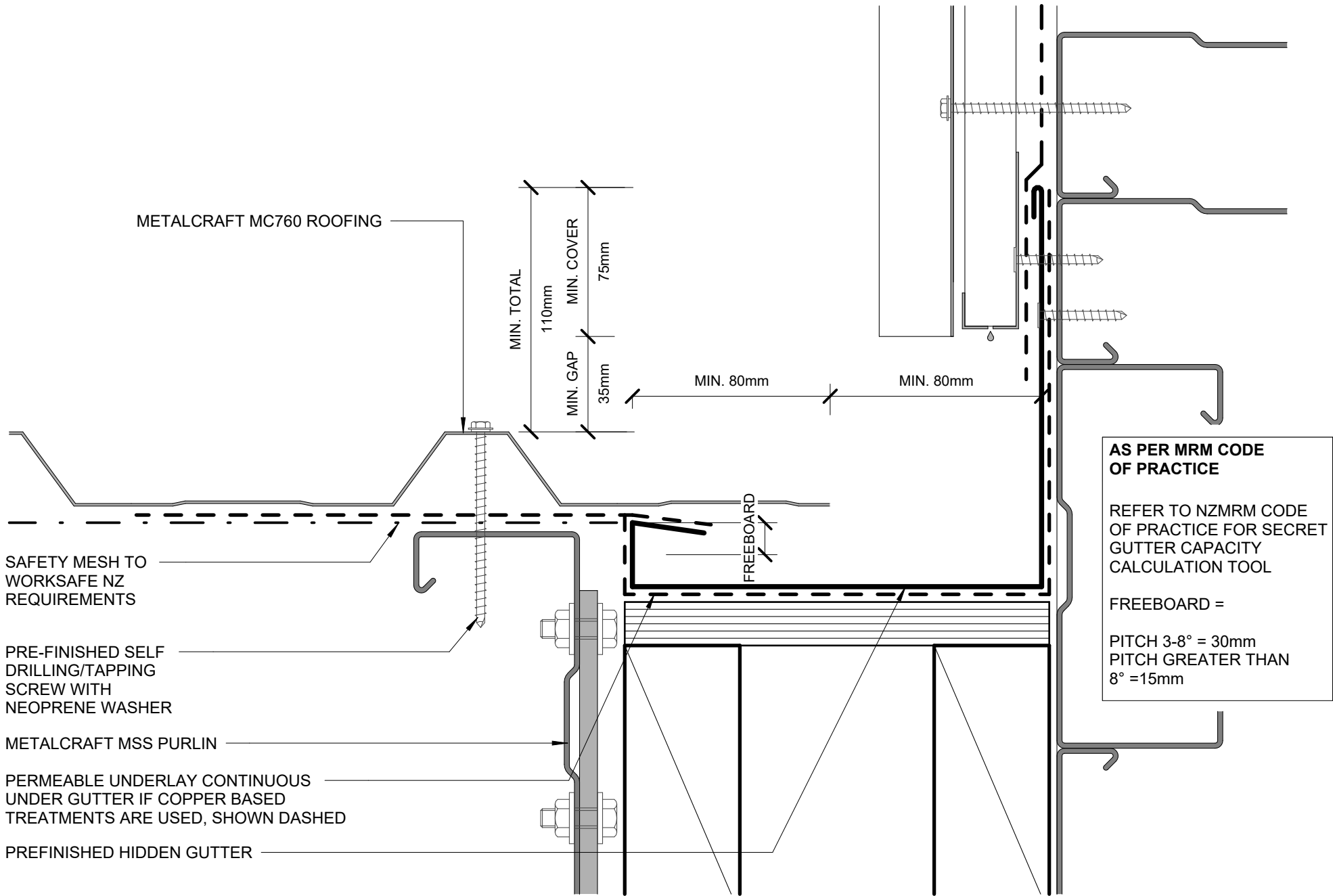

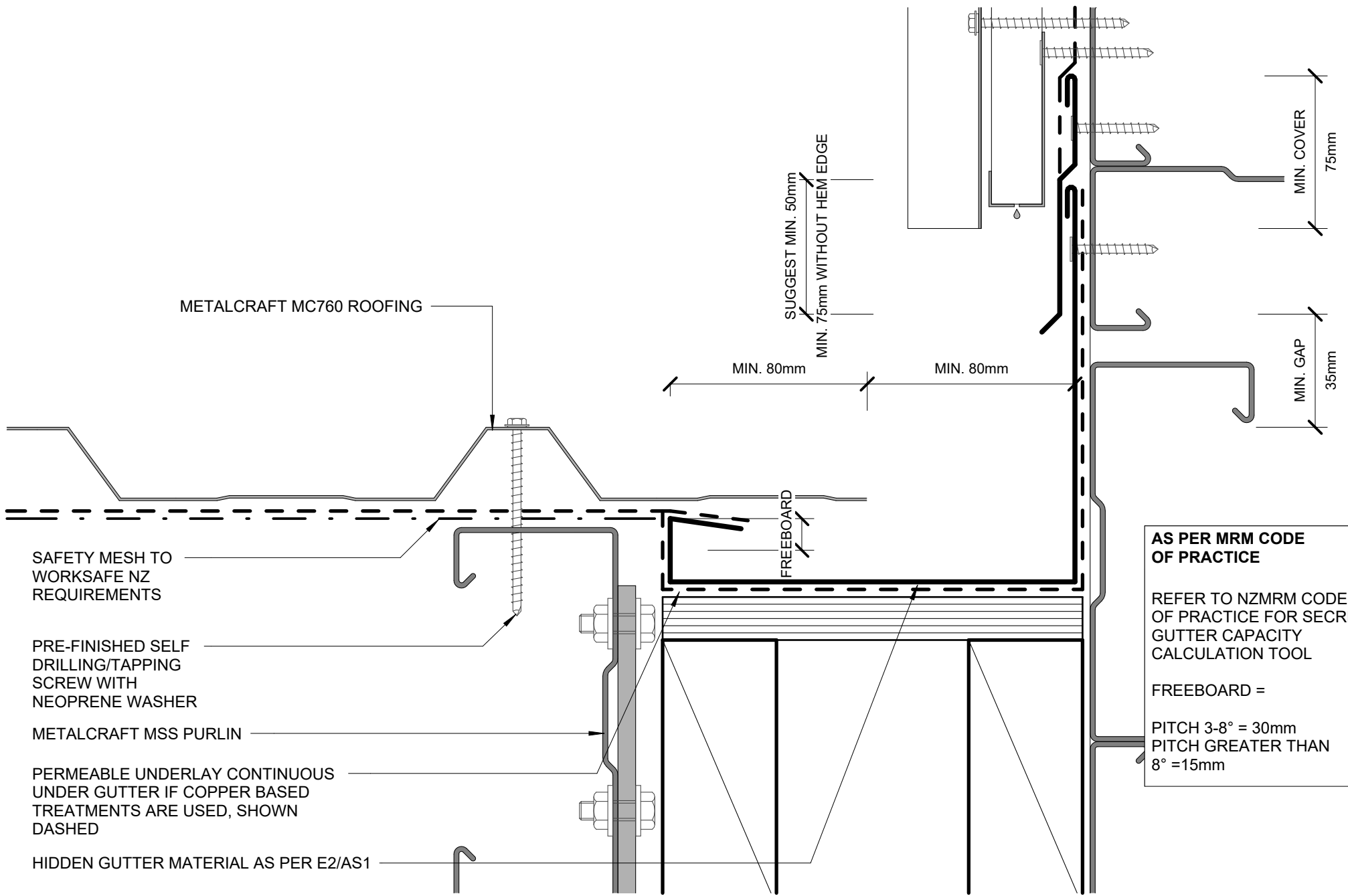

PARALLEL HIDDEN GUTTER (2 PART FLASHING)

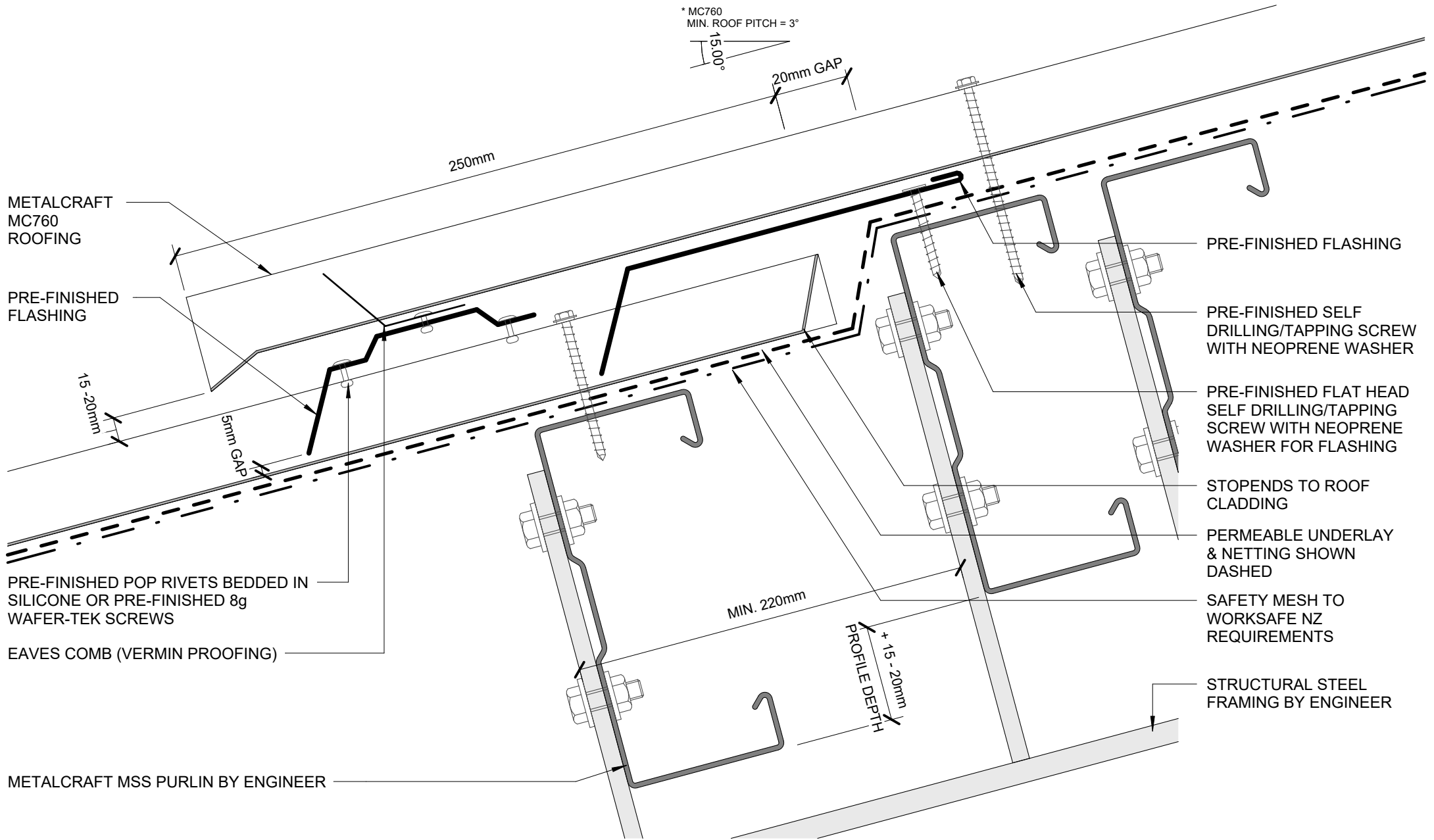

FIXING WITH PROFILED
WASHER AND EPDM
WASHER

ALSYNITE ONE NZ LTD
MC760 TRANSLUCENT
SHEET INSTALLED TO
MANUFACTURERS
RECOMMENDATION

PURLIN PROTECTION

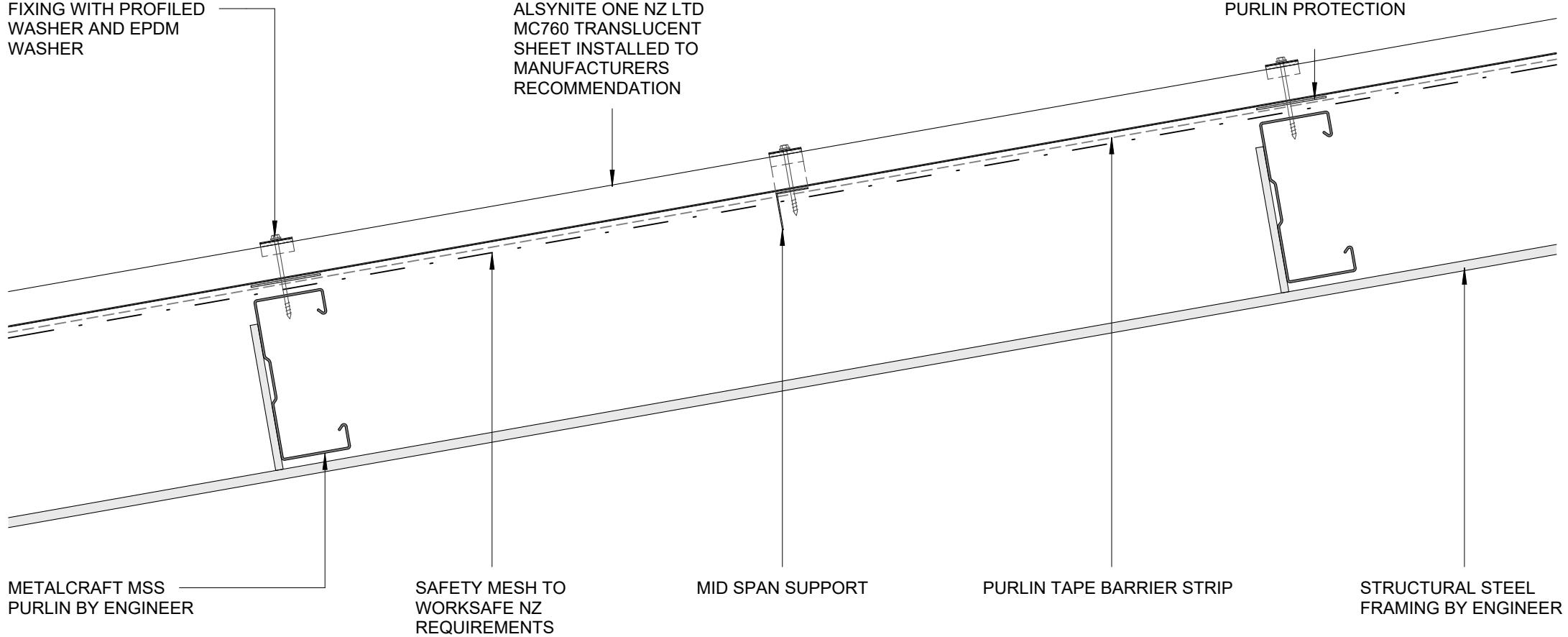

METALCRAFT MSS
PURLIN BY ENGINEER

SAFETY MESH TO
WORKSAFE NZ
REQUIREMENTS

MID SPAN SUPPORT

PURLIN TAPE BARRIER STRIP

STRUCTURAL STEEL
FRAMING BY ENGINEER

FIXING WITH PROFILED WASHER
AND EPDM WASHER

ALSYNITE ONE NZ LTD
MC760 TRANSLUCENT
SHEET INSTALLED TO
MANUFACTURERS
RECOMMENDATION

PURLIN PROTECTION

METALCRAFT MC760 ROOFING

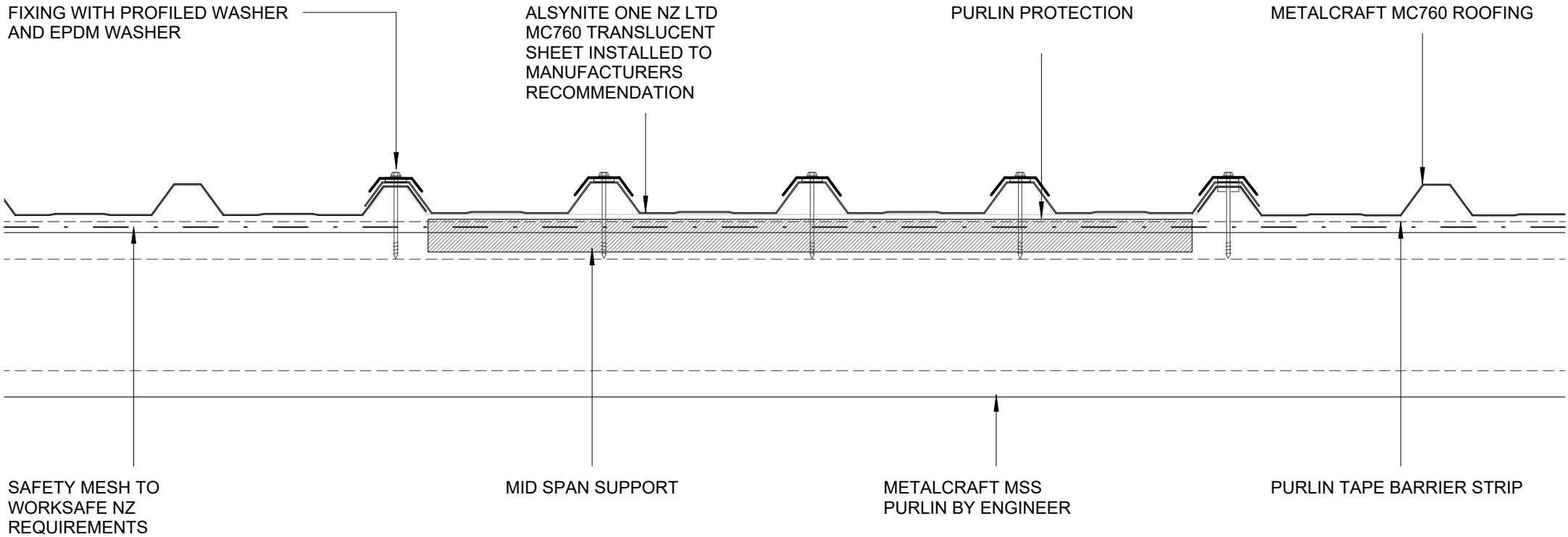

FIXING AND MID SPAN SUPPORT AS PER
ALSYNITE ONE NZ LTD LITERATURE
WWW.ALSYNITE.CO.NZ

