

Espan 340[®] / 470[®]

COMMERCIAL ROOFING

FOR ADDITIONAL DETAILS - REFER
TO RESIDENTIAL ROOFING ESPAN

DETAIL LIST

		<u>Revision</u>	<u>Date</u>
D 01	RIDGE WITH NON - PROFILED APEX	3.0	SEP 2024
D 02	SAWTOOTH RIDGE	3.0	SEP 2024
D 03	INTERNAL GUTTER	3.0	SEP 2024
D 04	FLUSH EAVE WITH EXTERNAL BRACKET	3.0	SEP 2024
D 05	BARGE WITH PROFILED CLADDING AND FASCIA	3.0	SEP 2024
D 06	PARAPET WITH TRANSVERSE APRON	3.0	SEP 2024
D 07	TRANSVERSE APRON	3.0	SEP 2024
D 08	PARALLEL APRON	3.0	SEP 2024
D 09	ALTERNATIVE FLASHING DESIGN	3.0	SEP 2024

AS PER E2/ASI			
	SITUATION 1	SITUATION 2	SITUATION 3
	1. LOW, MEDIUM, HIGH WIND ZONES, WHERE ROOF PITCH $\geq 10^\circ$	1. VERY HIGH WIND ZONE 2. LOW, MEDIUM AND HIGH WIND ZONES WHERE ROOF PITCH $\leq 10^\circ$	1. ALL ROOF PITCHES IN EXTRA HIGH WIND ZONE
X	MIN. 130mm (EXCLUDING ANY SOFT EDGE OR TURN-DOWN TO ROOFING)	MIN. 200mm (EXCLUDING ANY SOFT EDGE OR TURN-DOWN TO ROOFING)	MIN. 200mm (EXCLUDING ANY SOFT EDGE OR TURN-DOWN TO ROOFING)
Z	MIN. 50mm	MIN. 70mm	MIN. 90mm

AS PER MRM CODE OF PRACTICE				
	CATEGORY A	CATEGORY B	CATEGORY C	CATEGORY D
	LOW, MEDIUM OR HIGH WIND ZONES - ALL ROOF PITCHES VERY HIGH AND EXTRA HIGH WIND ZONES WHERE THE PITCH IS EQUAL TO OR GREATER THAN 10°	VERY HIGH WIND ZONES ROOF PITCH $< 8^\circ$ EXTRA HIGH WIND ZONES - ALL ROOF PITCHES	SED WIND ZONES UP TO 60 m/s ALL ROOF PITCH	SED WIND ZONES UP TO 68 m/s ALL ROOF PITCH
X	MIN. 130mm	MIN. 200mm	MIN. 200mm	MIN. 200mm + BAFFLE (REFER NZ MRM COP)
Z	MIN. 50mm (VERTICALLY DOWN FACE - SMOOTH) MIN. 75mm (VERTICALLY DOWN FACE - PROFILED)	MIN. 75mm (VERTICALLY DOWN FACE - SMOOTH) MIN. 100mm (VERTICALLY DOWN FACE - PROFILED)	MIN. 75mm (VERTICALLY DOWN FACE - SMOOTH) MIN. 125mm (VERTICALLY DOWN FACE - PROFILED)	MIN. 75mm (VERTICALLY DOWN FACE - SMOOTH) MIN. 125mm (VERTICALLY DOWN FACE - PROFILED)

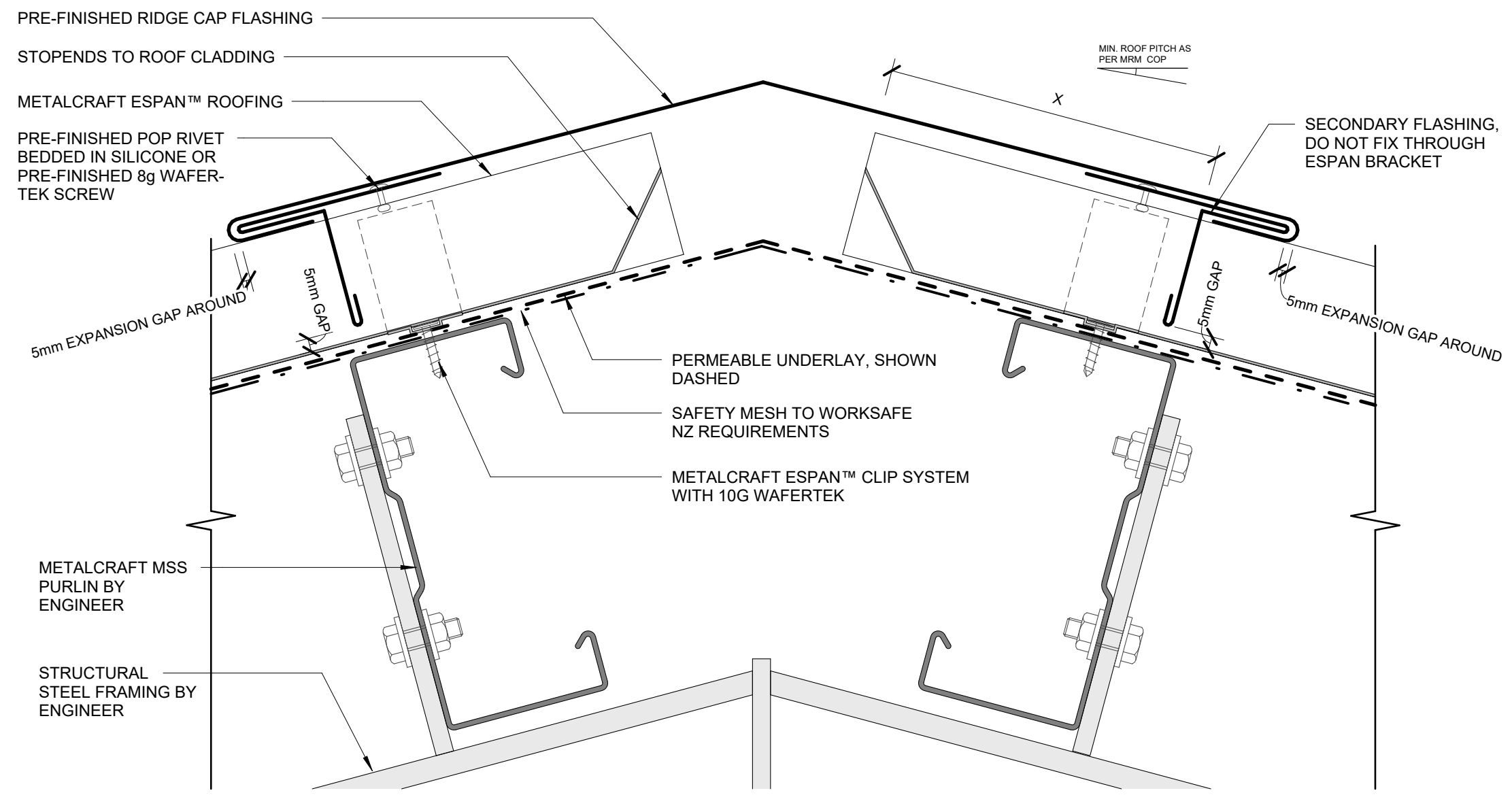

AS PER E2/ASI			
	SITUATION 1	SITUATION 2	SITUATION 3
	1. LOW, MEDIUM, HIGH WIND ZONES, WHERE ROOF PITCH $\geq 10^\circ$	1. VERY HIGH WIND ZONE 2. LOW, MEDIUM AND HIGH WIND ZONES WHERE ROOF PITCH $\leq 10^\circ$	1. ALL ROOF PITCHES IN EXTRA HIGH WIND ZONE
X	MIN. 130mm (EXCLUDING ANY SOFT EDGE OR TURN-DOWN TO ROOFING)	MIN. 200mm (EXCLUDING ANY SOFT EDGE OR TURN-DOWN TO ROOFING)	MIN. 200mm (EXCLUDING ANY SOFT EDGE OR TURN-DOWN TO ROOFING)
Z	MIN. 50mm	MIN. 70mm	MIN. 90mm

AS PER MRM CODE OF PRACTICE				
	CATEGORY A	CATEGORY B	CATEGORY C	CATEGORY D
	LOW, MEDIUM OR HIGH WIND ZONES - ALL ROOF PITCHES VERY HIGH AND EXTRA HIGH WIND ZONES WHERE THE PITCH IS EQUAL TO OR GREATER THAN 10°	VERY HIGH WIND ZONES ROOF PITCH $< 8^\circ$ EXTRA HIGH WIND ZONES - ALL ROOF PITCHES	SED WIND ZONES UP TO 60 m/s ALL ROOF PITCH	SED WIND ZONES UP TO 68 m/s ALL ROOF PITCH
X	MIN. 130mm	MIN. 200mm	MIN. 200mm	MIN. 200mm + BAFFLE (REFER NZ MRM COP)
Z	MIN. 50mm (VERTICALLY DOWN FACE - SMOOTH) MIN. 75mm (VERTICALLY DOWN FACE - PROFILED)	MIN. 75mm (VERTICALLY DOWN FACE - SMOOTH) MIN. 100mm (VERTICALLY DOWN FACE - PROFILED)	MIN. 75mm (VERTICALLY DOWN FACE - SMOOTH) MIN. 125mm (VERTICALLY DOWN FACE - PROFILED)	MIN. 75mm (VERTICALLY DOWN FACE - SMOOTH) MIN. 125mm (VERTICALLY DOWN FACE - PROFILED)

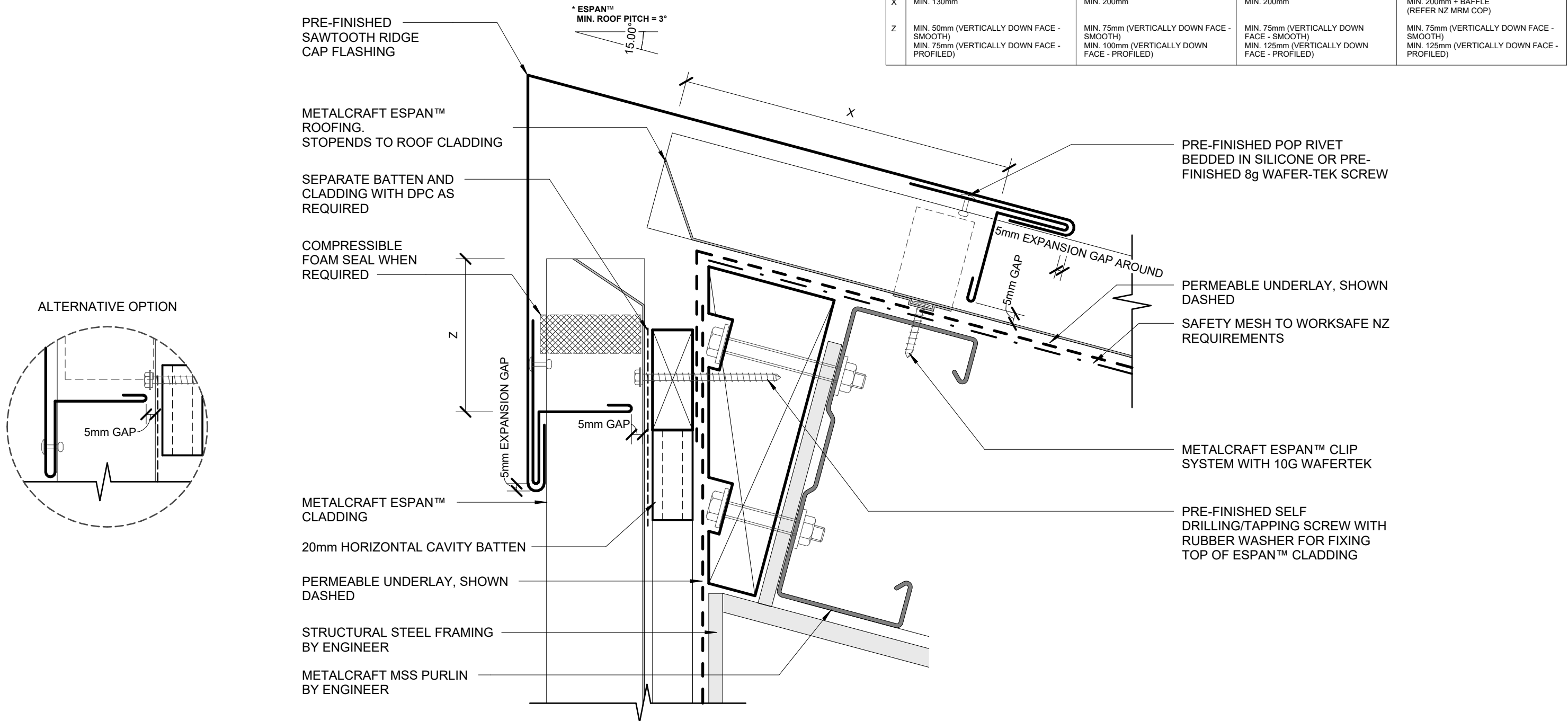

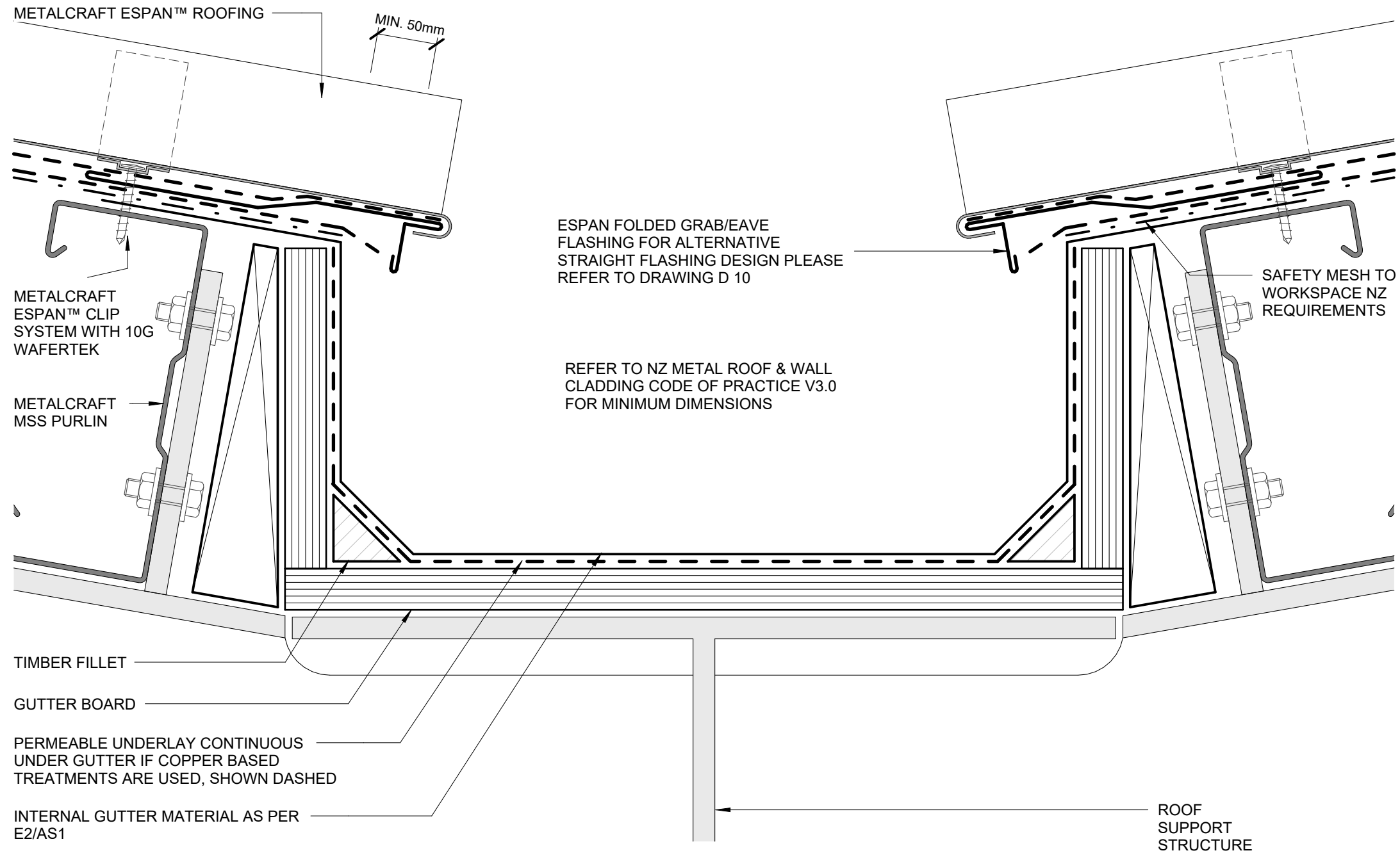

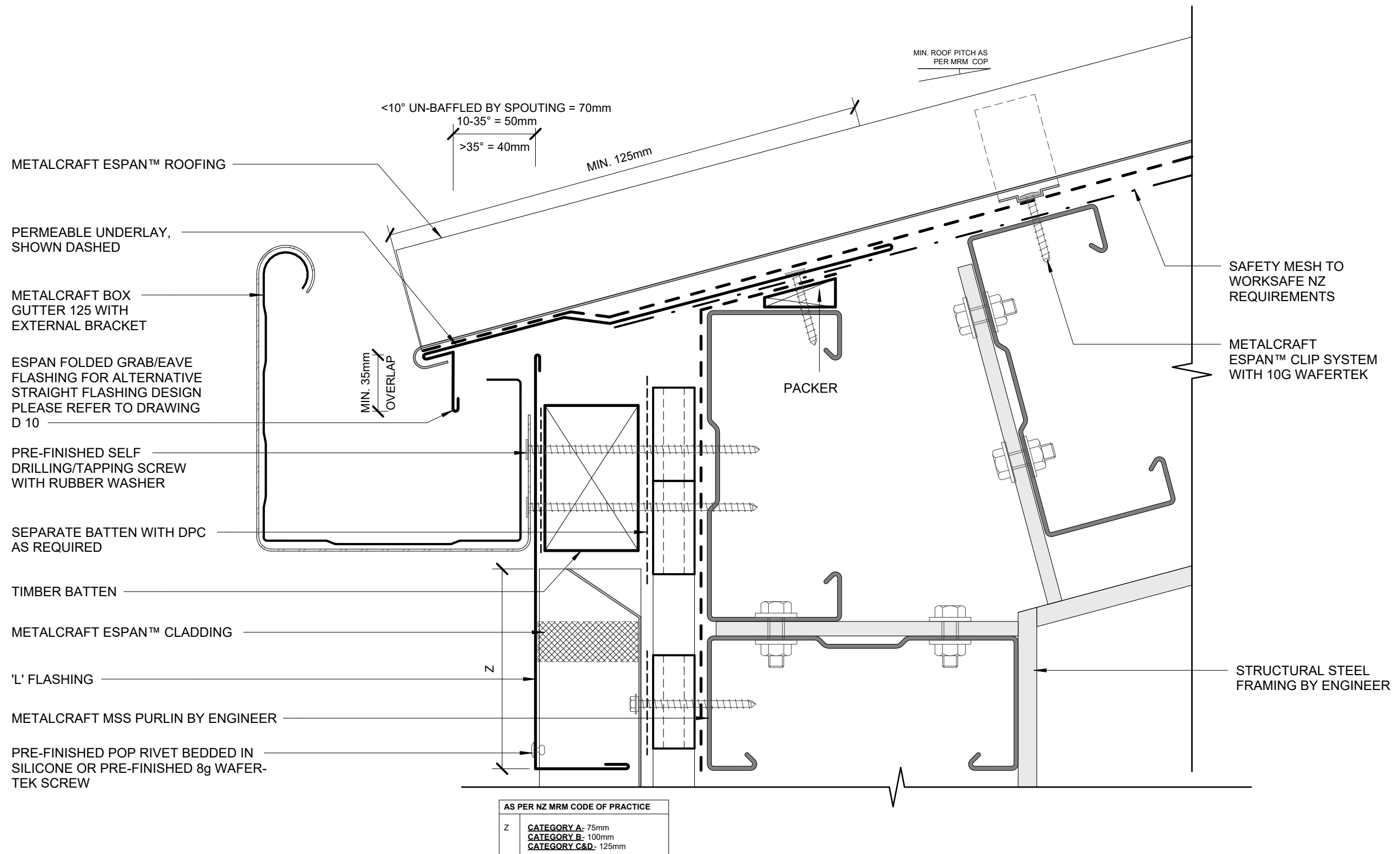

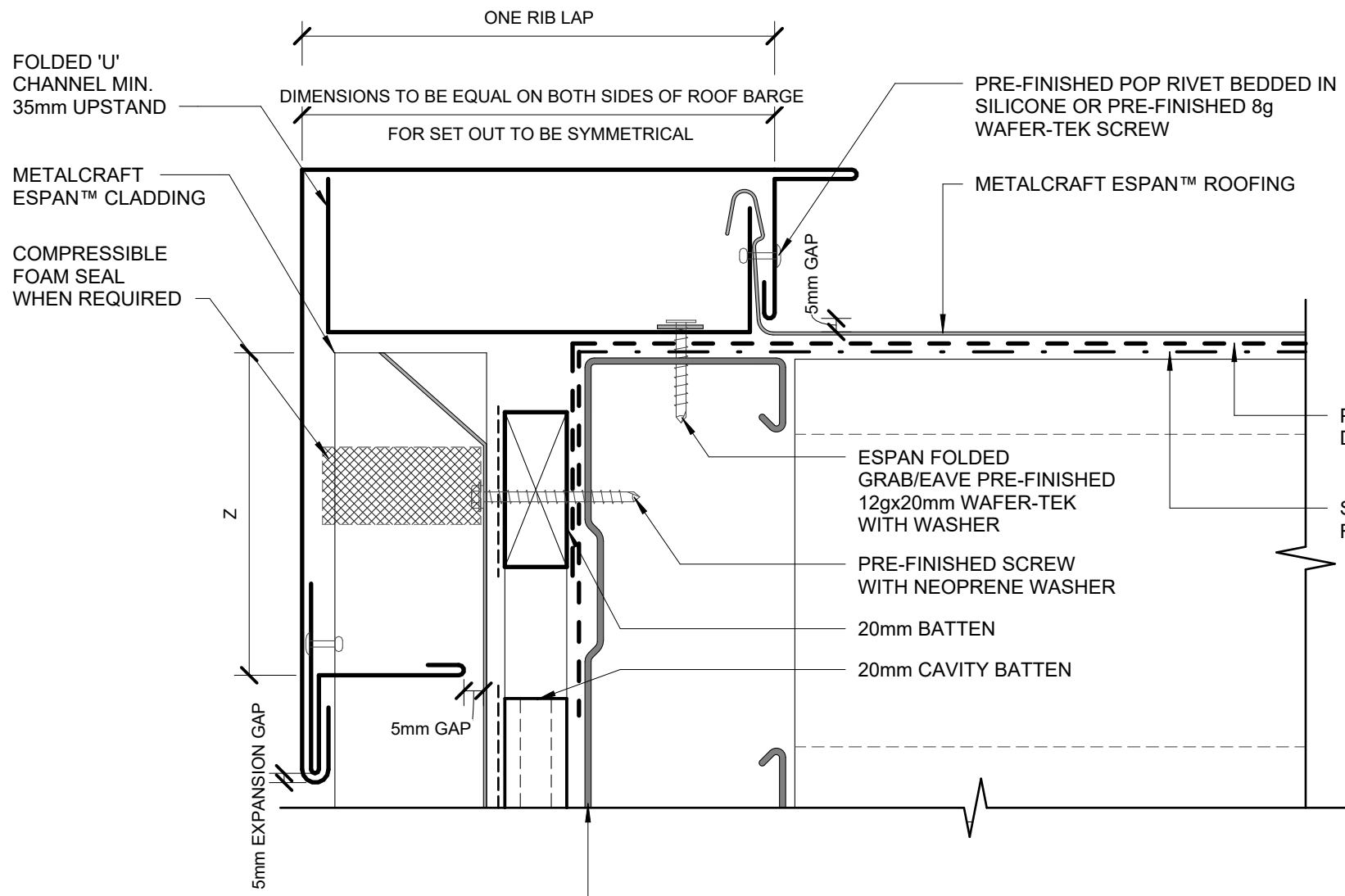

AS PER E2/ASI			
	SITUATION 1 1. LOW, MEDIUM, HIGH WIND ZONES, WHERE ROOF PITCH $\geq 10^\circ$	SITUATION 2 1. ALL ROOF PITCHES IN VERY HIGH WIND ZONE 2. LOW, MEDIUM, HIGH WIND ZONES WHERE ROOF PITCH $\leq 10^\circ$	SITUATION 3 1. FOR ALL ROOF PITCHES IN EXTRA HIGH WIND ZONES
Z	MIN. 50mm	MIN. 70mm	MIN. 90mm

AS PER MRM CODE OF PRACTICE			
	CATEGORY A LOW, MEDIUM OR HIGH WIND ZONES - ALL ROOF PITCHES VERY HIGH AND EXTRA HIGH WIND ZONES WHERE THE PITCH IS EQUAL TO OR GREATER THAN 10°	CATEGORY B VERY HIGH WIND ZONES ROOF PITCH $< 8^\circ$ EXTRA HIGH WIND ZONES - ALL ROOF PITCHES	CATEGORY C SED WIND ZONES UP TO 60 m/s ALL ROOF PITCH
Z	MIN. 50mm (VERTICALLY DOWN FACE - SMOOTH) MIN. 75mm (VERTICALLY DOWN FACE - PROFILED)	MIN. 75mm (VERTICALLY DOWN FACE - SMOOTH) MIN. 100mm (VERTICALLY DOWN FACE - PROFILED)	MIN. 100mm (VERTICALLY DOWN FACE - SMOOTH) MIN. 125mm (VERTICALLY DOWN FACE - PROFILED)

ALTERNATIVE OPTION WITH FASCIA

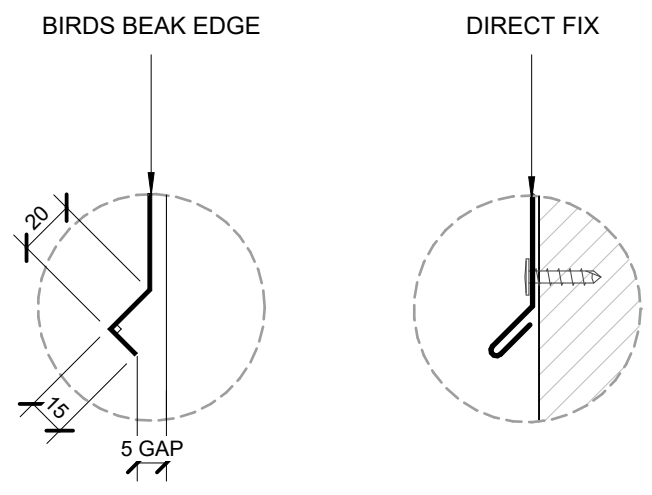
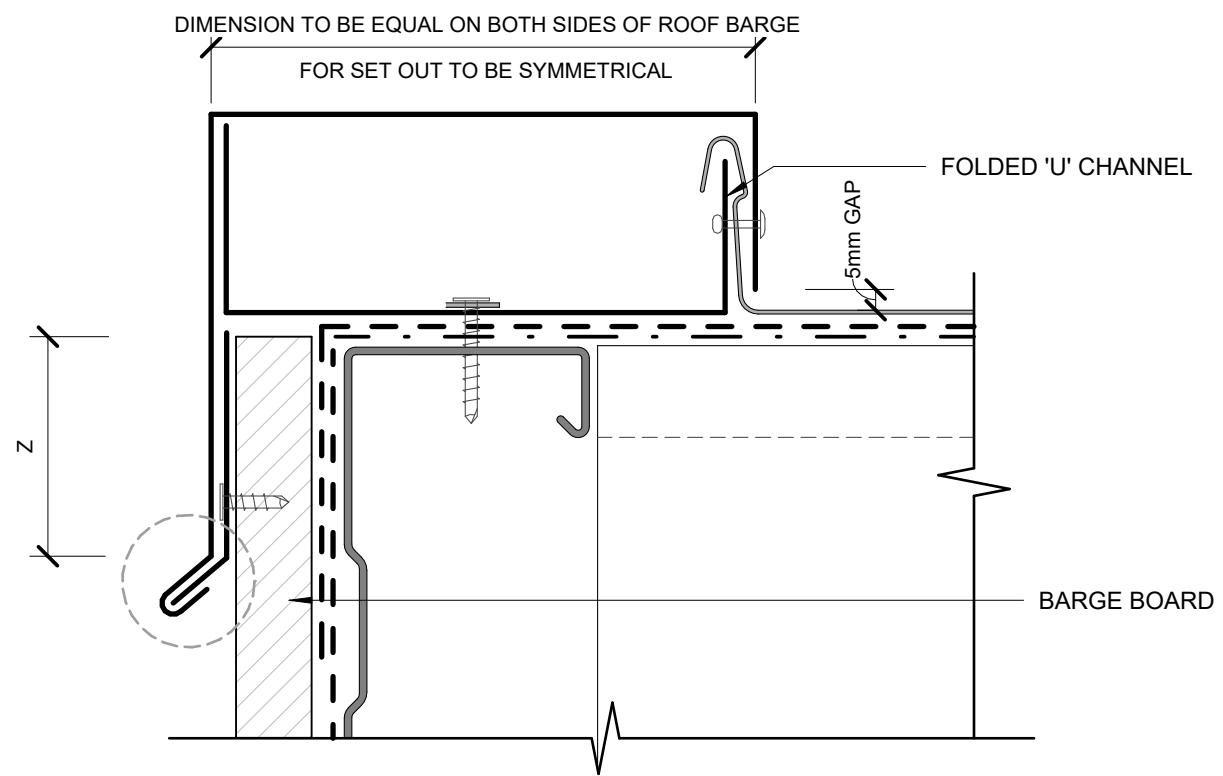

METALCRAFT MSS PURLIN BY ENGINEER

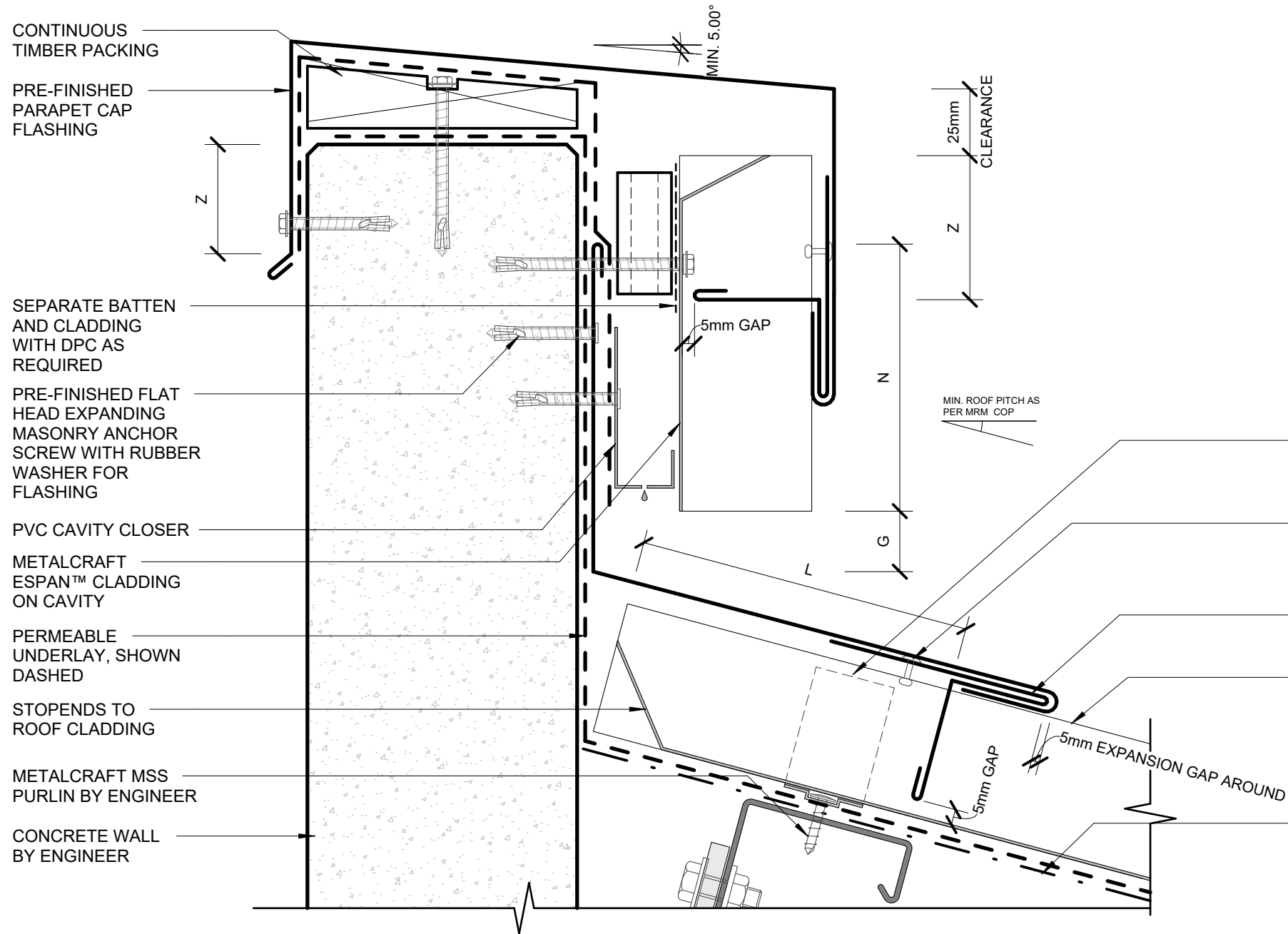

AS PER E2/ASI			
	SITUATION 1	SITUATION 2	SITUATION 3
	1. LOW, MEDIUM, HIGH WIND ZONES, WHERE ROOF PITCH $\geq 10^\circ$	1. VERY HIGH WIND ZONE 2. LOW, MEDIUM AND HIGH WIND ZONES WHERE ROOF PITCHES $\leq 10^\circ$	1. ALL ROOF PITCHES IN EXTRA HIGH WIND ZONE
G	MIN. 35mm	MIN. 35mm	MIN. 35mm
N	MIN. 75mm	MIN. 75mm	MIN. 75mm
L	MIN. 130mm (EXCLUDING ANY SOFT EDGE OR TURN-DOWN TO ROOFING)	MIN. 200mm (EXCLUDING ANY SOFT EDGE OR TURN-DOWN TO ROOFING)	MIN. 200mm (EXCLUDING ANY SOFT EDGE OR TURN-DOWN TO ROOFING)
Z	MIN. 50mm	MIN. 70mm	MIN. 90mm

AS PER MRM CODE OF PRACTICE				
	CATEGORY A	CATEGORY B	CATEGORY C	CATEGORY D
	LOW, MEDIUM OR HIGH WIND ZONES - ALL ROOF PITCHES VERY HIGH AND EXTRA HIGH WIND ZONES WHERE THE PITCH IS EQUAL TO OR GREATER THAN 10°	VERY HIGH WIND ZONES ROOF PITCH $< 8^\circ$ EXTRA HIGH WIND ZONES - ALL ROOF PITCHES	SED WIND ZONES UP TO 60 m/s ALL ROOF PITCH	SED WIND ZONES UP TO 68 m/s ALL ROOF PITCH
G	25mm	25mm	25mm	25mm
N	MIN. 50mm + HEM QR 75mm (VERTICALLY UP FACE - SMOOTH) MIN. 75mm + HEM QR 100mm (VERTICALLY UP FACE - PROFILED)	MIN. 75mm + HEM QR 100mm (VERTICALLY UP FACE - SMOOTH) MIN. 100mm + HEM QR 125mm (VERTICALLY UP FACE - PROFILED)	MIN. 100mm + HEM QR 125mm (VERTICALLY UP FACE - SMOOTH) MIN. 125mm + HEM (VERTICALLY UP FACE - PROFILED)	MIN. 100mm + HEM QR 125mm (VERTICALLY UP FACE - SMOOTH) MIN. 125mm + HEM (VERTICALLY UP FACE - PROFILED)
L	MIN. 130mm	MIN. 200mm	MIN. 200mm + BAFFLE (REFER NZ MRM COP)	MIN. 200mm + BAFFLE (REFER NZ MRM COP)
Z	MIN. 50mm (VERTICALLY DOWN FACE - SMOOTH) MIN. 75mm (VERTICALLY DOWN FACE - PROFILED)	MIN. 75mm (VERTICALLY DOWN FACE - SMOOTH) MIN. 100mm (VERTICALLY DOWN FACE - PROFILED)	MIN. 100mm (VERTICALLY DOWN FACE - SMOOTH) MIN. 125mm (VERTICALLY DOWN FACE - PROFILED)	MIN. 100mm (VERTICALLY DOWN FACE - SMOOTH) MIN. 125mm (VERTICALLY DOWN FACE - PROFILED)

- METALCRAFT ESPAN™ CLIP SYSTEM WITH 10G WAFERTEK
- PRE-FINISHED POP RIVET BEDDED IN SILICONE OR PRE-FINISHED 8g WAFER-TEK SCREW
- PRE-FINISHED APRON FLASHING
- METALCRAFT ESPAN™ ROOFING
- SAFETY MESH TO WORKSAFE NZ REQUIREMENTS

ALTERNATIVE OPTION

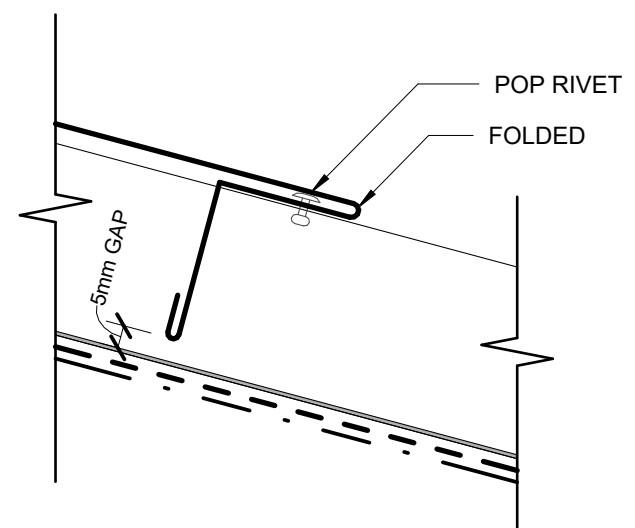

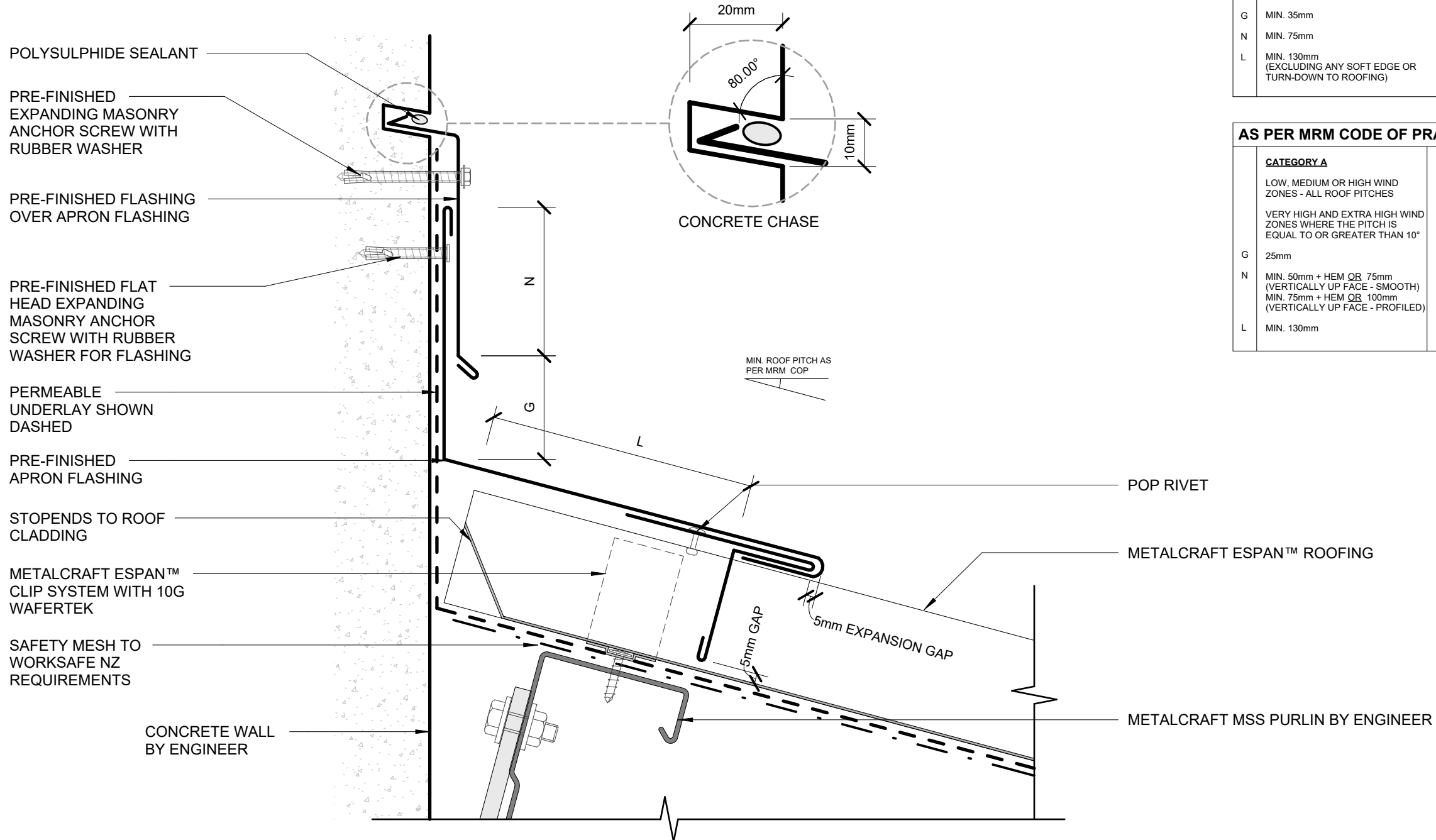

AS PER E2/ASI			
	SITUATION 1	SITUATION 2	SITUATION 3
	1. LOW, MEDIUM, HIGH WIND ZONES, WHERE ROOF PITCH $\geq 10^\circ$	1. ALL ROOF PITCHES IN VERY HIGH WIND ZONES 2. LOW, MEDIUM, AND HIGH WIND ZONES WHERE ROOF PITCH $\leq 10^\circ$	1. ALL ROOF PITCHES IN EXTRA HIGH WIND ZONE
G	MIN. 35mm	MIN. 35mm	MIN. 35mm
N	MIN. 75mm	MIN. 75mm	MIN. 75mm
L	MIN. 130mm (EXCLUDING ANY SOFT EDGE OR TURN-DOWN TO ROOFING)	MIN. 200mm (EXCLUDING ANY SOFT EDGE OR TURN-DOWN TO ROOFING)	MIN. 200mm (EXCLUDING ANY SOFT EDGE OR TURN-DOWN TO ROOFING)

AS PER MRM CODE OF PRACTICE				
	CATEGORY A	CATEGORY B	CATEGORY C	CATEGORY D
	LOW, MEDIUM OR HIGH WIND ZONES - ALL ROOF PITCHES	VERY HIGH WIND ZONES ROOF PITCH $< 8^\circ$	SED WIND ZONES UP TO 60 m/s	SED WIND ZONES UP TO 68 m/s
	VERY HIGH AND EXTRA HIGH WIND ZONES WHERE THE PITCH IS EQUAL TO OR GREATER THAN 10°	EXTRA HIGH WIND ZONES - ALL ROOF PITCHES	ALL ROOF PITCH	ALL ROOF PITCH
G	25mm	25mm	25mm	25mm
N	MIN. 50mm + HEM OR 75mm (VERTICALLY UP FACE - SMOOTH) MIN. 75mm + HEM OR 100mm (VERTICALLY UP FACE - PROFILED)	MIN. 75mm + HEM OR 100mm (VERTICALLY UP FACE - SMOOTH) MIN. 100mm + HEM OR 125mm (VERTICALLY UP FACE - PROFILED)	MIN. 100mm + HEM OR 125mm (VERTICALLY UP FACE - SMOOTH) MIN. 125mm + HEM (VERTICALLY UP FACE - PROFILED)	MIN. 100mm + HEM OR 125mm (VERTICALLY UP FACE - SMOOTH) MIN. 125mm + HEM (VERTICALLY UP FACE - PROFILED)
L	MIN. 130mm	MIN. 200mm	MIN. 200mm + BAFFLE (REFER NZ MRM COP)	MIN. 200mm + BAFFLE (REFER NZ MRM COP)

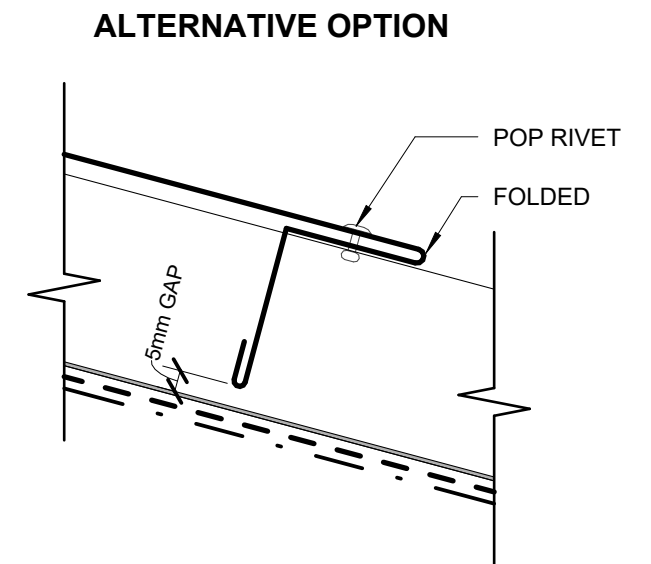

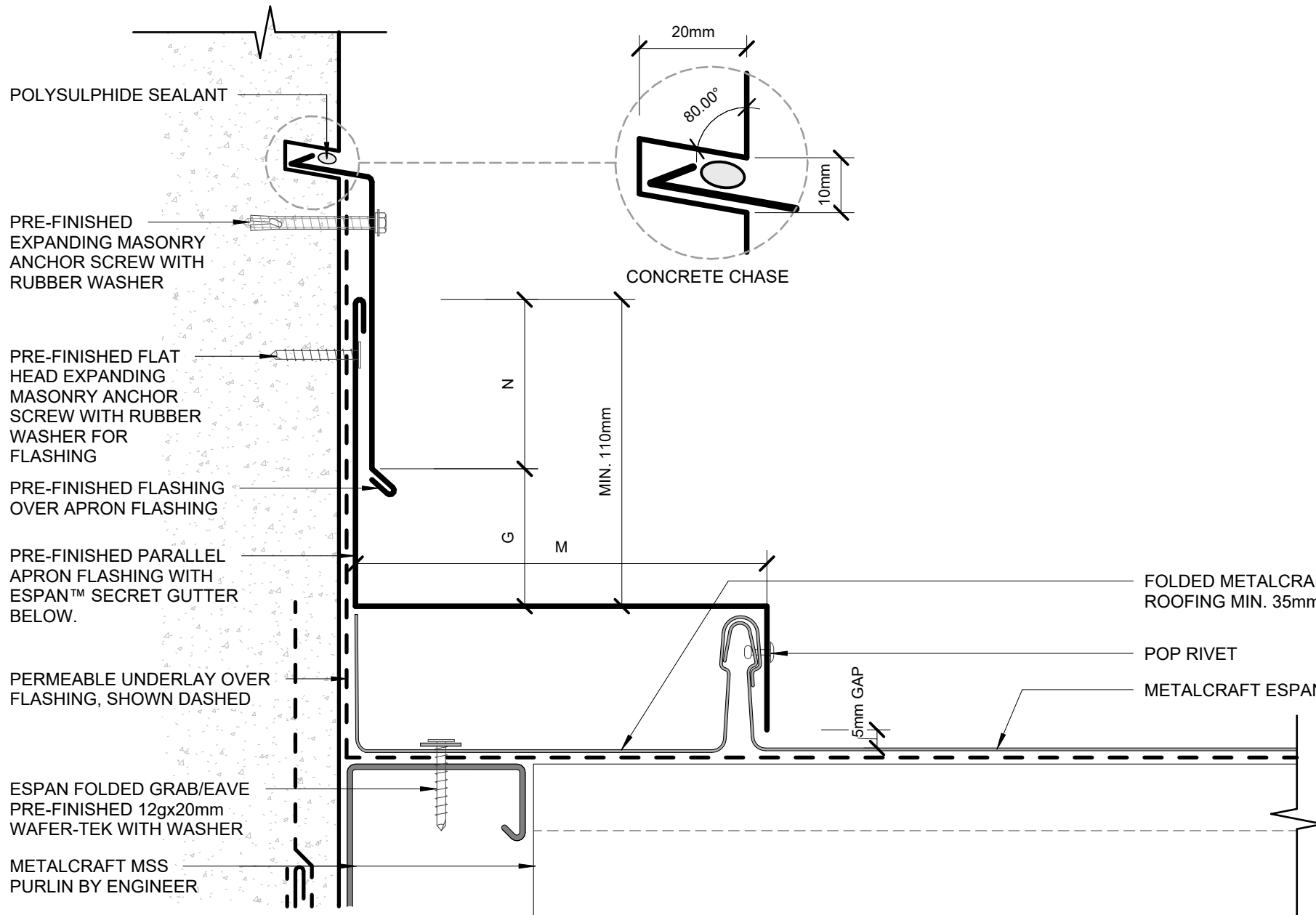

ALTERNATIVE OPTION - A

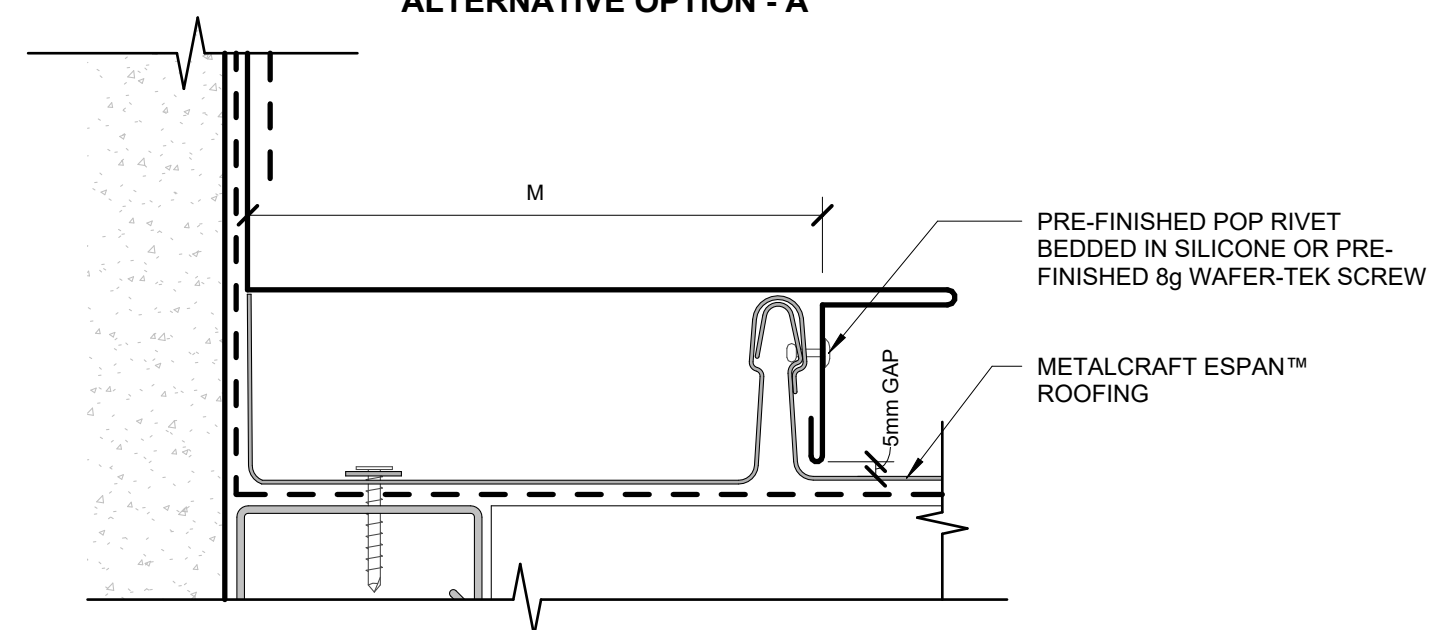

ALTERNATIVE OPTION - B

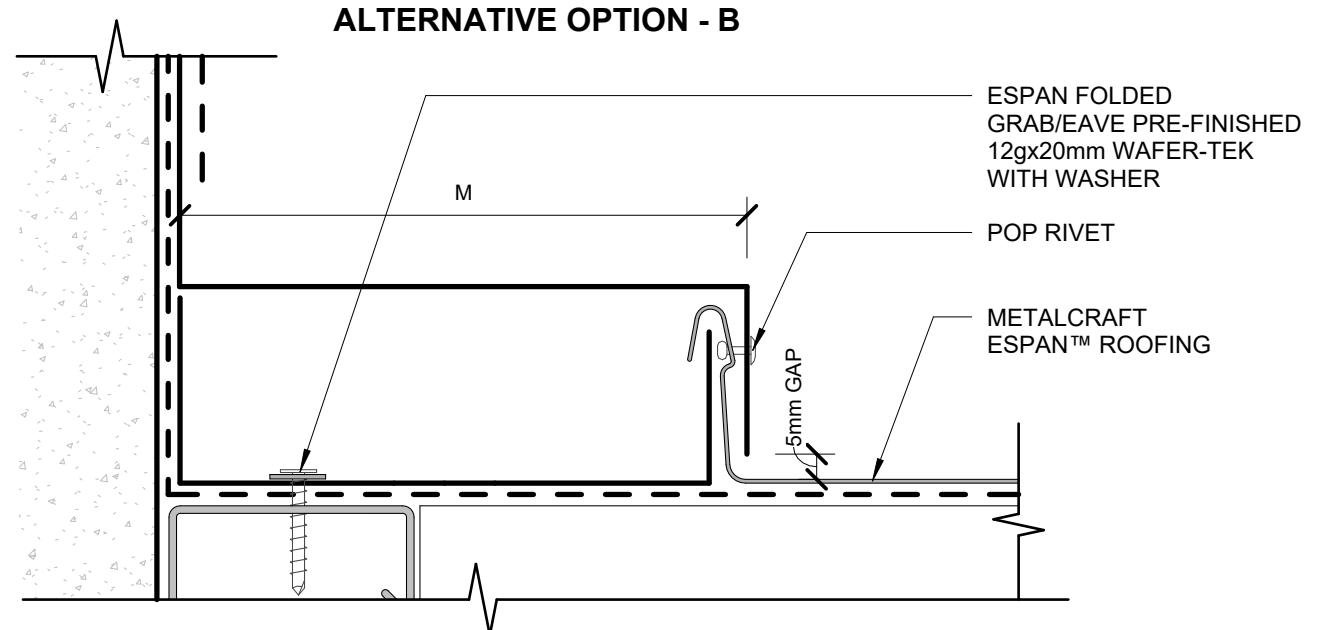

AS PER E2/ASI			
	SITUATION 1	SITUATION 2	SITUATION 3
	1. LOW, MEDIUM, HIGH WIND ZONES, WHERE ROOF PITCH $\geq 10^\circ$	1. ALL ROOF PITCHES IN VERY HIGH WIND ZONE 2. LOW, MEDIUM, AND HIGH WIND ZONES WHERE ROOF PITCH $\leq 10^\circ$	1. ALL ROOF PITCHES IN EXTRA HIGH WIND ZONE
G	MIN. 35mm	MIN. 35mm	MIN. 35mm
N	MIN. 75mm	MIN. 75mm	MIN. 75mm
M	AT LEAST TWO CRESTS	AT LEAST TWO CRESTS	AT LEAST TWO CRESTS

AS PER MRM CODE OF PRACTICE				
	CATEGORY A	CATEGORY B	CATEGORY C	CATEGORY D
	LOW, MEDIUM OR HIGH WIND ZONES - ALL ROOF PITCHES VERY HIGH AND EXTRA HIGH WIND ZONES WHERE THE PITCH IS EQUAL TO OR GREATER THAN 10°	VERY HIGH WIND ZONES ROOF PITCH $< 8^\circ$ EXTRA HIGH WIND ZONES - ALL ROOF PITCHES	SED WIND ZONES UP TO 60 m/s ALL ROOF PITCH	SED WIND ZONES UP TO 68 m/s ALL ROOF PITCH
G	25mm	25mm	25mm	25mm
N	MIN. 50mm + HEM OR 75mm (VERTICALLY UP FACE - SMOOTH) MIN. 75mm + HEM OR 100mm (VERTICALLY UP FACE - PROFILED)	MIN. 75mm + HEM OR 100mm (VERTICALLY UP FACE - SMOOTH) MIN. 100mm + HEM OR 125mm (VERTICALLY UP FACE - PROFILED)	MIN. 100mm + HEM OR 125mm (VERTICALLY UP FACE - SMOOTH) MIN. 125mm + HEM (VERTICALLY UP FACE - PROFILED)	MIN. 100mm + HEM OR 125mm (VERTICALLY UP FACE - SMOOTH) MIN. 125mm + HEM (VERTICALLY UP FACE - PROFILED)
M	TRAPEZOIDAL & TRAY: ONE RIB CORRUGATE: 2 CORRUGATIONS	TRAPEZOIDAL & TRAY: TWO RIBS (20mm - 34mm)* ONE RIB (>34mm)* CORRUGATE: 2 CORRUGATIONS	TRAPEZOIDAL & TRAY: TWO RIBS (20mm - 34mm)* ONE RIB (>34mm)* CORRUGATE: 3 CORRUGATIONS	TRAPEZOIDAL & TRAY: TWO RIBS (20mm - 34mm)* + UNDERSOAKER ONE RIB (>34mm)* + UNDERSOAKER CORRUGATE: 2 CORRUGATIONS + UNDERSOAKER
* RIB HEIGHT OF PROFILE OR TURNUP				

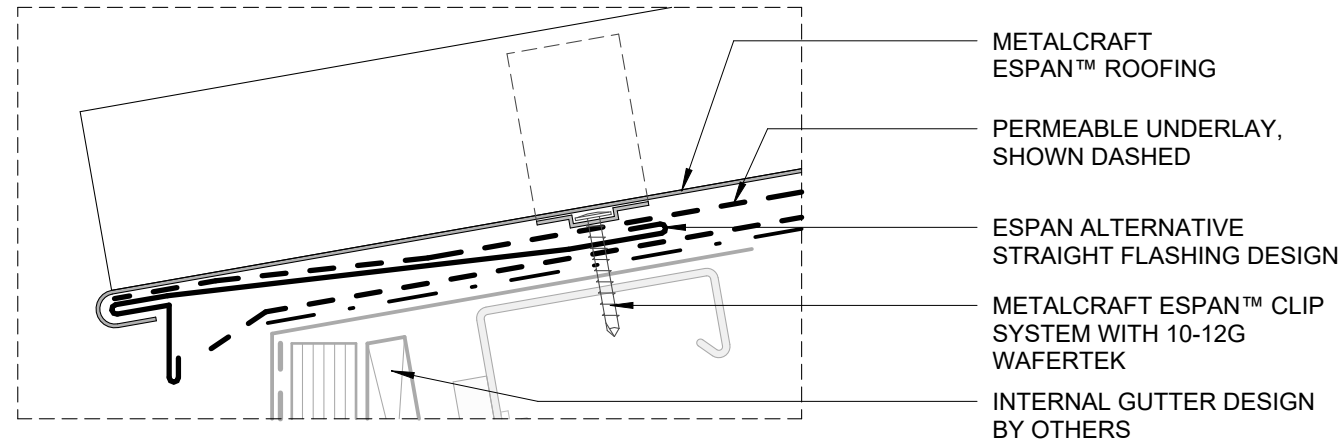

ALTERNATIVE STRAIGHT FLASHING DESIGN FOR INTERNAL GUTTER

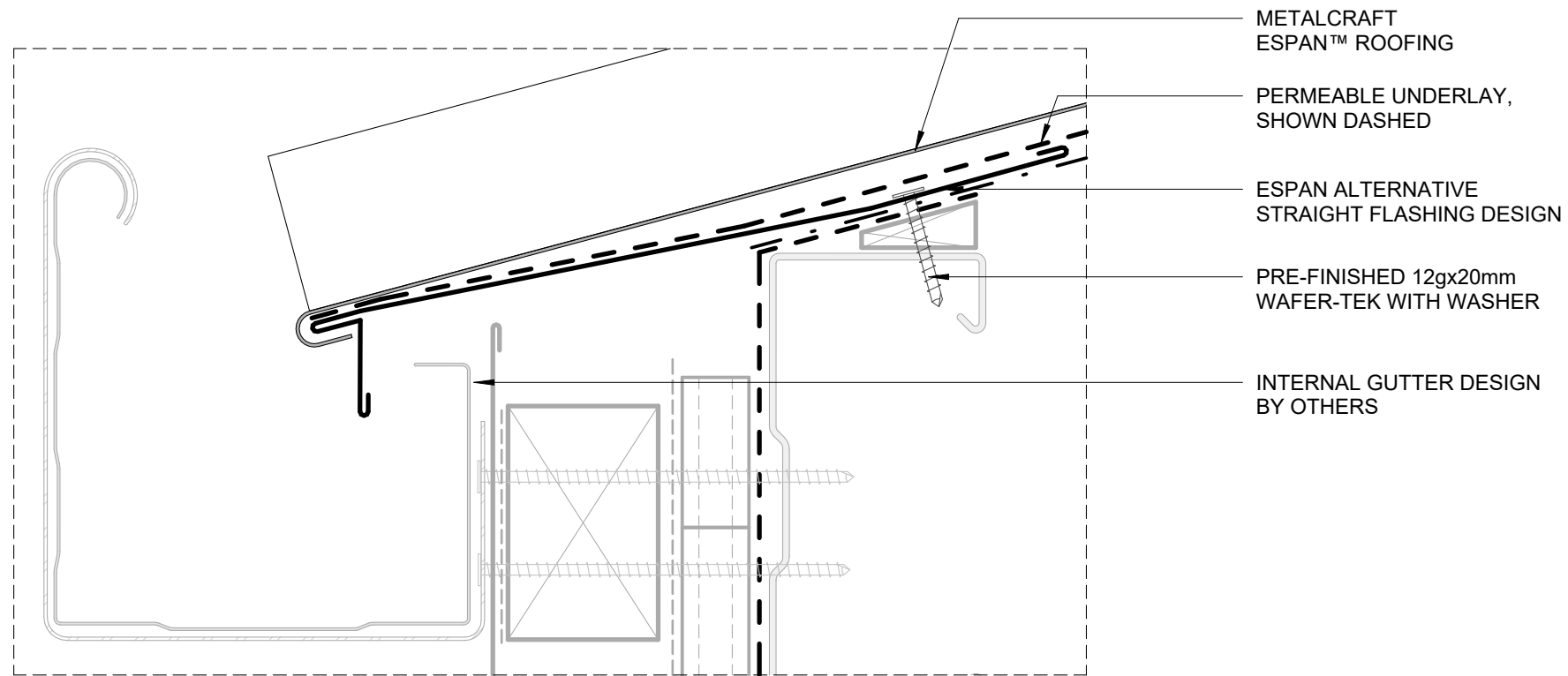

ALTERNATIVE STRAIGHT FLASHING DESIGN FOR GUTTER EAVE